

RERA NO: PO2400005677

P R E S T I G E
CLAIREMONT

K O K A P E T

C O M E H O M E T O H A P P I N E S S

L I V E
T H E N E W
L I F E I N
N E O P O L I S



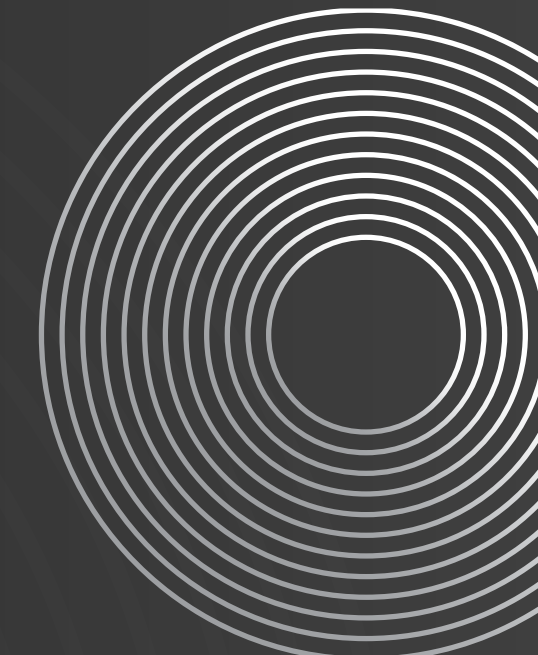

Prestige Clairemont is located in Neopolis, a newly established, futuristic, 500+ acre layout in Kokapet, which extends from the financial district.

LIVE IN THE FUTURE OF HYDERABAD

Neopolis has been planned by the Telangana Government to set a benchmark for the whole country for advanced infrastructural planning and smart living. This is where future Hyderabad is taking shape.

With no zonal and height restrictions, it is a self-contained neighbourhood with a superb mix of commercial and premium residential developments.

THE FUTURE IS HERE



IF YOU WANT TO EXPERIENCE WHAT IT WILL BE LIKE
TO LIVE IN THE FUTURE, THIS IS WHERE YOU START.

ENJOY RAPID & SMOOTH ACCESS

Neopolis has an excellent network of broad 100ft wide roads and promises short and easy commutes. All social needs – schools, shopping, healthcare, entertainment, leisure – are a short drive away.

The Neopolis Trumpet Road gives you smooth and seamless access to the Outer Ring Road thereby enabling rapid connectivity to the rest of Hyderabad.

Image Credit: Neopolis/HMDA



LEGEND

PRESTIGE PROPERTIES

1. Prestige High Fields
2. Prestige Beverly Hills
3. Prestige Tranquil
4. Prestige Ivy League
5. Prestige Royal Woods

EDUCATION INSTITUTIONS

1. CBIT
2. Birla Open Minds Pre School
3. Gaudium School
4. Tata Institute of Fundamental Research
5. Oakridge International School
6. CHIREC International School
7. MIIT

HOSPITALS

1. Continental Hospitals
2. AIG Hospitals
3. Care Hospitals
4. KIMS Hospital

WORK SPOTS

1. Amazon
2. GAR Infobahn
3. Google
4. Wipro
5. Microsoft
6. Infosys

HOTELS

1. Sheraton Hyderabad Hotel
2. Hyatt Hyderabad Gachibowli

OTHERS

1. US Consulate
2. Golconda Fort



Artist's Impression

INTELLIGENT PLANNING ENABLES INCREDIBLE LIVING

Prestige Clairemont enables you to enjoy an incredibly elevated living experience in intelligently planned and finely crafted three and four bed homes.

The homes are spacious and offer an excellent choice of plans, to suit both those who prefer efficient use of space and those who love more expansive rooms. In both cases, you will find ample usable floor area thanks to smart planning.

With no common walls between 2 apartments, every home receives abundant natural light and ventilation.

Ultimately, these homes are about enabling you to live the lifestyle that you are accustomed to, without compromise.

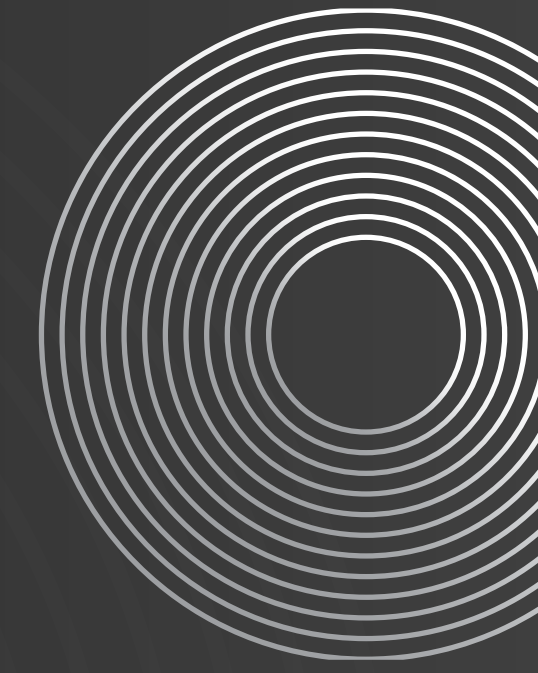

MASTER PLAN

SITE AREA	7.56 acres
NO. OF UNITS	928 homes

LEGEND

- | | | |
|-------------------------------|----------------------|--------------------------|
| 01. Entry / Exit | 07. Net Cricket | 13. Pet Park |
| 02. Arrival Plaza | 08. Skate Park | 14. Multipurpose Lawn |
| 03. Drop Off | 09. Tennis Court | 15. Swimming Pool & Deck |
| 04. Driveway | 10. Basketball Court | 16. Kids' Pool |
| 05. Entry / Exit From Parking | 11. Kids' Play Area | 17. Jogging Track |
| 06. Visitors' Car Parks | 12. Seating Plaza | |



NUMBERING PLAN

LEGEND			
COLOUR	UNIT TYPE	NO. OF BED	AREA
Blue	UNIT A	3B3T	1989 SFT
Light Blue	UNIT B	3B3T	1988 SFT
Orange	UNIT C	3B3T	2003 SFT
Red	UNIT D	3 BHK LARGE	2257 SFT
Light Blue	UNIT E	3 BHK LARGE	2257 SFT
Red	UNIT F	3B3T + S	2710 SFT
Purple	UNIT G	3B3T + S + M	2838 SFT
Dark Blue	UNIT H	3B3T + S	2870 SFT
Grey	UNIT J	3B3T + S + M	2944 SFT
Green	UNIT K	4B4T + M	3500 SFT
Orange	UNIT L	4B4T + M	3536 SFT
Red	UNIT M	4B4T + M	4037 SFT
Dark Blue	UNIT N	4B4T + M	4060 SFT



NUMBERING PLAN

LEGEND			
COLOUR	UNIT TYPE	NO. OF BED	AREA
Light Blue	UNIT - G1	3B3T + S + M	2838 SFT
Dark Blue	UNIT - H1	3B3T + S	2870 SFT
Light Green	UNIT - J1	3B3T + S + M	2944 SFT
Light Yellow	UNIT - K1	4B4T + M	3500 SFT
Light Purple	UNIT - L1	4B4T + M	3536 SFT
Light Orange	UNIT - M1	4B4T + M	4037 SFT
Light Pink	UNIT - N1	4B4T + M	4060 SFT

Tower - 01 & 04 (36th to 38th Floors)

Tower - 02 & 03 (32nd & 33rd Floors)



EXTERIOR VIEW



GROUND FLOOR PLAN

LEGEND			
COLOUR	UNIT TYPE	NO. OF BED	AREA
UNIT A	3B3T	1989 SFT	
UNIT B	3B3T	1988 SFT	
UNIT C	3B3T	2003 SFT	
UNIT D	3 BHK LARGE	2257 SFT	
UNIT E	3 BHK LARGE	2257 SFT	
UNIT F	3B3T + S	2710 SFT	
UNIT G	3B3T + S + M	2838 SFT	
UNIT - G1	3B3T +S + M	2838 SFT	
UNIT H	3B3T + S	2870 SFT	
UNIT - H1	3B3T + S	2870 SFT	
UNIT J	3B3T + S + M	2944 SFT	
UNIT - J1	3B3T +S + M	2944 SFT	
UNIT K	4B4T + M	3500 SFT	
UNIT - K1	4B4T + M	3500 SFT	
UNIT L	4B4T + M	3536 SFT	
UNIT - L1	4B4T + M	3536 SFT	
UNIT M	4B4T + M	4037 SFT	
UNIT - M1	4B4T + M	4037 SFT	
UNIT N	4B4T + M	4060 SFT	
UNIT - N1	4B4T + M	4060 SFT	

LEGEND

- 01. Walking / Jogging Track
- 02. Multipurpose Lawn
- 03. Swimming Pool and Pool Deck
- 04. Kids' Pool
- 05. Poolside Lounges
- 06. Seating Lounges / Interactive Seating
- 07. Cafe
- 08. Yoga Area
- 09. Hammock Area



FIRST & SECOND FLOOR PLAN

LEGEND			
COLOUR	UNIT TYPE	NO. OF BED	AREA
UNIT A	3B3T	1989 SFT	
UNIT B	3B3T	1988 SFT	
UNIT C	3B3T	2003 SFT	
UNIT D	3 BHK LARGE	2257 SFT	
UNIT E	3 BHK LARGE	2257 SFT	
UNIT F	3B3T + S	2710 SFT	
UNIT G	3B3T + S + M	2838 SFT	
UNIT - G1	3B3T +S + M	2838 SFT	
UNIT H	3B3T + S	2870 SFT	
UNIT - H1	3B3T + S	2870 SFT	
UNIT J	3B3T + S + M	2944 SFT	
UNIT - J1	3B3T +S + M	2944 SFT	
UNIT K	4B4T + M	3500 SFT	
UNIT - K1	4B4T + M	3500 SFT	
UNIT L	4B4T + M	3536 SFT	
UNIT - L1	4B4T + M	3536 SFT	
UNIT M	4B4T + M	4037 SFT	
UNIT - M1	4B4T + M	4037 SFT	
UNIT N	4B4T + M	4060 SFT	
UNIT - N1	4B4T + M	4060 SFT	



EXTERIOR VIEW



TYPICAL FLOOR PLAN

LEGEND			
COLOUR	UNIT TYPE	NO. OF BED	AREA
Blue	UNIT A	3B3T	1989 SFT
Purple	UNIT B	3B3T	1988 SFT
Orange	UNIT C	3B3T	2003 SFT
Red	UNIT D	3 BHK LARGE	2257 SFT
Grey	UNIT E	3 BHK LARGE	2257 SFT
Dark Red	UNIT F	3B3T + S	2710 SFT
Light Purple	UNIT G	3B3T + S + M	2838 SFT
Gold	UNIT - G1	3B3T +S + M	2838 SFT
Dark Green	UNIT H	3B3T + S	2870 SFT
Light Green	UNIT - H1	3B3T + S	2870 SFT
Brown	UNIT J	3B3T + S + M	2944 SFT
Dark Blue	UNIT - J1	3B3T +S + M	2944 SFT
Light Green	UNIT K	4B4T + M	3500 SFT
Green	UNIT - K1	4B4T + M	3500 SFT
Orange	UNIT L	4B4T + M	3536 SFT
Yellow	UNIT - L1	4B4T + M	3536 SFT
Pink	UNIT M	4B4T + M	4037 SFT
Red	UNIT - M1	4B4T + M	4037 SFT
Dark Green	UNIT N	4B4T + M	4060 SFT
Dark Green	UNIT - N1	4B4T + M	4060 SFT

Tower - 01 & 04 (3rd to 13th Floors)

Tower - 02 & 03 (3rd to 11th Floors)



REFUGE FLOOR PLAN

LEGEND			
COLOUR	UNIT TYPE	NO. OF BED	AREA
[Dark Blue]	UNIT A	3B3T	1989 SFT
[Light Blue]	UNIT B	3B3T	1988 SFT
[Orange]	UNIT C	3B3T	2003 SFT
[Red]	UNIT D	3 BHK LARGE	2257 SFT
[Light Blue]	UNIT E	3 BHK LARGE	2257 SFT
[Red]	UNIT F	3B3T + S	2710 SFT
[Purple]	UNIT G	3B3T + S + M	2838 SFT
[Brown]	UNIT - G1	3B3T +S + M	2838 SFT
[Dark Blue]	UNIT H	3B3T + S	2870 SFT
[Light Blue]	UNIT - H1	3B3T + S	2870 SFT
[Purple]	UNIT J	3B3T + S + M	2944 SFT
[Dark Blue]	UNIT - J1	3B3T +S + M	2944 SFT
[Green]	UNIT K	4B4T + M	3500 SFT
[Light Green]	UNIT - K1	4B4T + M	3500 SFT
[Yellow]	UNIT L	4B4T + M	3536 SFT
[Light Yellow]	UNIT - L1	4B4T + M	3536 SFT
[Red]	UNIT M	4B4T + M	4037 SFT
[Dark Red]	UNIT - M1	4B4T + M	4037 SFT
[Dark Green]	UNIT N	4B4T + M	4060 SFT
[Dark Green]	UNIT - N1	4B4T + M	4060 SFT

Tower - 01 & 04 (14th Floor)

Tower - 02 & 03 (12th Floor)



15th FLOOR PLAN

LEGEND			
COLOUR	UNIT TYPE	NO. OF BED	AREA
[Dark Blue]	UNIT A	3B3T	1989 SFT
[Light Blue]	UNIT B	3B3T	1988 SFT
[Orange]	UNIT C	3B3T	2003 SFT
[Red]	UNIT D	3 BHK LARGE	2257 SFT
[Light Blue]	UNIT E	3 BHK LARGE	2257 SFT
[Red]	UNIT F	3B3T + S	2710 SFT
[Purple]	UNIT G	3B3T + S + M	2838 SFT
[Brown]	UNIT - G1	3B3T +S + M	2838 SFT
[Dark Blue]	UNIT H	3B3T + S	2870 SFT
[Light Blue]	UNIT - H1	3B3T + S	2870 SFT
[Purple]	UNIT J	3B3T + S + M	2944 SFT
[Dark Blue]	UNIT - J1	3B3T +S + M	2944 SFT
[Green]	UNIT K	4B4T + M	3500 SFT
[Light Green]	UNIT - K1	4B4T + M	3500 SFT
[Yellow]	UNIT L	4B4T + M	3536 SFT
[Light Yellow]	UNIT - L1	4B4T + M	3536 SFT
[Red]	UNIT M	4B4T + M	4037 SFT
[Dark Red]	UNIT - M1	4B4T + M	4037 SFT
[Dark Green]	UNIT N	4B4T + M	4060 SFT
[Dark Green]	UNIT - N1	4B4T + M	4060 SFT



TYPICAL FLOOR PLAN

LEGEND			
COLOUR	UNIT TYPE	NO. OF BED	AREA
[Purple]	UNIT A	3B3T	1989 SFT
[Light Purple]	UNIT B	3B3T	1988 SFT
[Orange]	UNIT C	3B3T	2003 SFT
[Red]	UNIT D	3 BHK LARGE	2257 SFT
[Blue-Gray]	UNIT E	3 BHK LARGE	2257 SFT
[Red-Orange]	UNIT F	3B3T + S	2710 SFT
[Purple-Gray]	UNIT G	3B3T + S + M	2838 SFT
[Brown]	UNIT - G1	3B3T +S + M	2838 SFT
[Dark Blue-Gray]	UNIT H	3B3T + S	2870 SFT
[Dark Blue]	UNIT - H1	3B3T + S	2870 SFT
[Dark Purple]	UNIT J	3B3T + S + M	2944 SFT
[Dark Blue-Gray]	UNIT - J1	3B3T +S + M	2944 SFT
[Light Green]	UNIT K	4B4T + M	3500 SFT
[Green]	UNIT - K1	4B4T + M	3500 SFT
[Yellow-Orange]	UNIT L	4B4T + M	3536 SFT
[Yellow]	UNIT - L1	4B4T + M	3536 SFT
[Red-Orange]	UNIT M	4B4T + M	4037 SFT
[Red]	UNIT - M1	4B4T + M	4037 SFT
[Dark Green]	UNIT N	4B4T + M	4060 SFT
[Dark Green]	UNIT - N1	4B4T + M	4060 SFT

Tower - 01 & 04 (16th to 23rd, 25th to 33rd & 35th Floors)

Tower - 02 & 03 (13th to 20th, 22nd to 29th & 31st Floors)



REFUGE FLOOR PLAN

LEGEND			
COLOUR	UNIT TYPE	NO. OF BED	AREA
[Purple]	UNIT A	3B3T	1989 SFT
[Light Purple]	UNIT B	3B3T	1988 SFT
[Orange]	UNIT C	3B3T	2003 SFT
[Red]	UNIT D	3 BHK LARGE	2257 SFT
[Blue-Gray]	UNIT E	3 BHK LARGE	2257 SFT
[Red-Orange]	UNIT F	3B3T + S	2710 SFT
[Purple-Gray]	UNIT G	3B3T + S + M	2838 SFT
[Brown]	UNIT - G1	3B3T +S + M	2838 SFT
[Dark Blue-Gray]	UNIT H	3B3T + S	2870 SFT
[Dark Blue]	UNIT - H1	3B3T + S	2870 SFT
[Dark Purple]	UNIT J	3B3T + S + M	2944 SFT
[Dark Blue-Gray]	UNIT - J1	3B3T +S + M	2944 SFT
[Light Green]	UNIT K	4B4T + M	3500 SFT
[Green]	UNIT - K1	4B4T + M	3500 SFT
[Yellow-Orange]	UNIT L	4B4T + M	3536 SFT
[Yellow]	UNIT - L1	4B4T + M	3536 SFT
[Red-Orange]	UNIT M	4B4T + M	4037 SFT
[Red]	UNIT - M1	4B4T + M	4037 SFT
[Dark Green]	UNIT N	4B4T + M	4060 SFT
[Dark Green]	UNIT - N1	4B4T + M	4060 SFT

Tower - 01 & 04 (24th & 34th Floors)

Tower - 02 & 03 (21st & 30th Floors)



TYPICAL FLOOR PLAN

LEGEND			
COLOUR	UNIT TYPE	NO. OF BED	AREA
	UNIT A	3B3T	1989 SFT
	UNIT B	3B3T	1988 SFT
	UNIT C	3B3T	2003 SFT
	UNIT D	3 BHK LARGE	2257 SFT
	UNIT E	3 BHK LARGE	2257 SFT
	UNIT F	3B3T + S	2710 SFT
	UNIT G	3B3T + S + M	2838 SFT
	UNIT - G1	3B3T +S + M	2838 SFT
	UNIT H	3B3T + S	2870 SFT
	UNIT - H1	3B3T + S	2870 SFT
	UNIT J	3B3T + S + M	2944 SFT
	UNIT - J1	3B3T +S + M	2944 SFT
	UNIT K	4B4T + M	3500 SFT
	UNIT - K1	4B4T + M	3500 SFT
	UNIT L	4B4T + M	3536 SFT
	UNIT - L1	4B4T + M	3536 SFT
	UNIT M	4B4T + M	4037 SFT
	UNIT - M1	4B4T + M	4037 SFT
	UNIT N	4B4T + M	4060 SFT
	UNIT - N1	4B4T + M	4060 SFT

Tower - 01 & 04 (36th to 38th Floors)

Tower - 02 & 03 (32nd & 33rd Floors)



EXTERIOR VIEW



TOWER - 01 (Ground Floor Plan)

LEGEND			
COLOUR	UNIT TYPE	NO. OF BED	AREA
[Red]	UNIT A	3B3T	1989 SFT
[Purple]	UNIT B	3B3T	1988 SFT
[Orange]	UNIT C	3B3T	2003 SFT
[Light Blue]	UNIT D	3 BHK LARGE	2257 SFT
[Dark Blue]	UNIT E	3 BHK LARGE	2257 SFT
[Pink]	UNIT F	3B3T + S	2710 SFT
[Light Purple]	UNIT G	3B3T + S + M	2838 SFT
[Brown]	UNIT - G1	3B3T +S + M	2838 SFT
[Dark Green]	UNIT H	3B3T + S	2870 SFT
[Light Green]	UNIT - H1	3B3T + S	2870 SFT
[Grey]	UNIT J	3B3T + S + M	2944 SFT
[Dark Grey]	UNIT - J1	3B3T +S + M	2944 SFT
[Light Green]	UNIT K	4B4T + M	3500 SFT
[Green]	UNIT - K1	4B4T + M	3500 SFT
[Yellow]	UNIT L	4B4T + M	3536 SFT
[Light Yellow]	UNIT - L1	4B4T + M	3536 SFT
[Pink]	UNIT M	4B4T + M	4037 SFT
[Red]	UNIT - M1	4B4T + M	4037 SFT
[Dark Green]	UNIT N	4B4T + M	4060 SFT
[Dark Green]	UNIT - N1	4B4T + M	4060 SFT



LEGEND

- 01. Hammock Area
- 02. Seating Lounges

TOWER - 01 (1st & 2nd Floor Plan)

LEGEND			
COLOUR	UNIT TYPE	NO. OF BED	AREA
[Red]	UNIT A	3B3T	1989 SFT
[Purple]	UNIT B	3B3T	1988 SFT
[Orange]	UNIT C	3B3T	2003 SFT
[Light Blue]	UNIT D	3 BHK LARGE	2257 SFT
[Dark Blue]	UNIT E	3 BHK LARGE	2257 SFT
[Pink]	UNIT F	3B3T + S	2710 SFT
[Light Purple]	UNIT G	3B3T + S + M	2838 SFT
[Brown]	UNIT - G1	3B3T +S + M	2838 SFT
[Dark Green]	UNIT H	3B3T + S	2870 SFT
[Light Green]	UNIT - H1	3B3T + S	2870 SFT
[Grey]	UNIT J	3B3T + S + M	2944 SFT
[Dark Grey]	UNIT - J1	3B3T +S + M	2944 SFT
[Light Green]	UNIT K	4B4T + M	3500 SFT
[Green]	UNIT - K1	4B4T + M	3500 SFT
[Yellow]	UNIT L	4B4T + M	3536 SFT
[Light Yellow]	UNIT - L1	4B4T + M	3536 SFT
[Pink]	UNIT M	4B4T + M	4037 SFT
[Red]	UNIT - M1	4B4T + M	4037 SFT
[Dark Green]	UNIT N	4B4T + M	4060 SFT
[Dark Green]	UNIT - N1	4B4T + M	4060 SFT

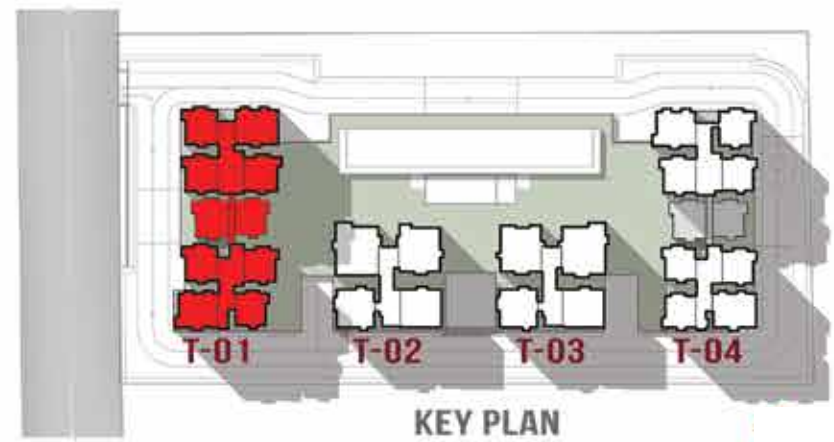
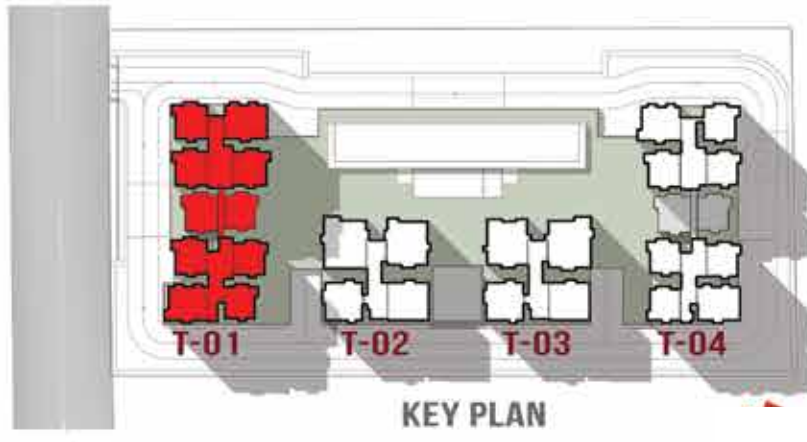

TOWER - 01 (Typical 3rd to 13th Floors)

LEGEND			
COLOUR	UNIT TYPE	NO. OF BED	AREA
UNIT A	3B3T	3	1989 SFT
UNIT B	3B3T	3	1988 SFT
UNIT C	3B3T	3	2003 SFT
UNIT D	3 BHK LARGE	3	2257 SFT
UNIT E	3 BHK LARGE	3	2257 SFT
UNIT F	3B3T + S	3	2710 SFT
UNIT G	3B3T + S + M	3	2838 SFT
UNIT - G1	3B3T +S + M	3	2838 SFT
UNIT H	3B3T + S	3	2870 SFT
UNIT - H1	3B3T + S	3	2870 SFT
UNIT J	3B3T + S + M	3	2944 SFT
UNIT - J1	3B3T +S + M	3	2944 SFT
UNIT K	4B4T + M	4	3500 SFT
UNIT - K1	4B4T + M	4	3500 SFT
UNIT L	4B4T + M	4	3536 SFT
UNIT - L1	4B4T + M	4	3536 SFT
UNIT M	4B4T + M	4	4037 SFT
UNIT - M1	4B4T + M	4	4037 SFT
UNIT N	4B4T + M	4	4060 SFT
UNIT - N1	4B4T + M	4	4060 SFT

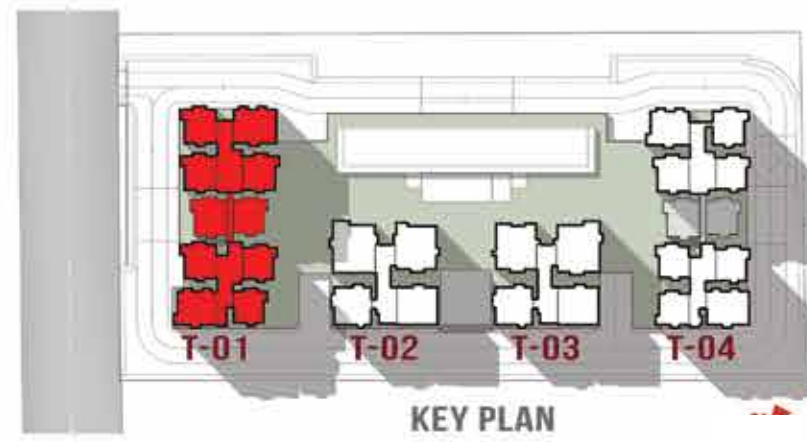

TOWER - 01 (Refuge Floor - 14th Floor)

LEGEND			
COLOUR	UNIT TYPE	NO. OF BED	AREA
UNIT A	3B3T	3	1989 SFT
UNIT B	3B3T	3	1988 SFT
UNIT C	3B3T	3	2003 SFT
UNIT D	3 BHK LARGE	3	2257 SFT
UNIT E	3 BHK LARGE	3	2257 SFT
UNIT F	3B3T + S	3	2710 SFT
UNIT G	3B3T + S + M	3	2838 SFT
UNIT - G1	3B3T +S + M	3	2838 SFT
UNIT H	3B3T + S	3	2870 SFT
UNIT - H1	3B3T + S	3	2870 SFT
UNIT J	3B3T + S + M	3	2944 SFT
UNIT - J1	3B3T +S + M	3	2944 SFT
UNIT K	4B4T + M	4	3500 SFT
UNIT - K1	4B4T + M	4	3500 SFT
UNIT L	4B4T + M	4	3536 SFT
UNIT - L1	4B4T + M	4	3536 SFT
UNIT M	4B4T + M	4	4037 SFT
UNIT - M1	4B4T + M	4	4037 SFT
UNIT N	4B4T + M	4	4060 SFT
UNIT - N1	4B4T + M	4	4060 SFT

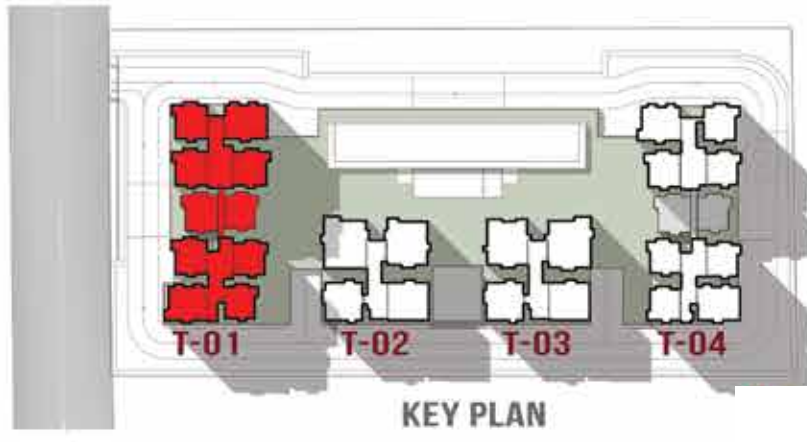

TOWER - 01 (15th Floor)

LEGEND			
COLOUR	UNIT TYPE	NO. OF BED	AREA
UNIT A	3B3T	3B3T	1989 SFT
UNIT B	3B3T	3B3T	1988 SFT
UNIT C	3B3T	3B3T	2003 SFT
UNIT D	3 BHK LARGE	3 BHK LARGE	2257 SFT
UNIT E	3 BHK LARGE	3 BHK LARGE	2257 SFT
UNIT F	3B3T + S	3B3T + S	2710 SFT
UNIT G	3B3T + S + M	3B3T + S + M	2838 SFT
UNIT - G1	3B3T +S + M	3B3T +S + M	2838 SFT
UNIT H	3B3T + S	3B3T + S	2870 SFT
UNIT - H1	3B3T + S	3B3T + S	2870 SFT
UNIT J	3B3T + S + M	3B3T + S + M	2944 SFT
UNIT - J1	3B3T +S + M	3B3T +S + M	2944 SFT
UNIT K	4B4T + M	4B4T + M	3500 SFT
UNIT - K1	4B4T + M	4B4T + M	3500 SFT
UNIT L	4B4T + M	4B4T + M	3536 SFT
UNIT - L1	4B4T + M	4B4T + M	3536 SFT
UNIT M	4B4T + M	4B4T + M	4037 SFT
UNIT - M1	4B4T + M	4B4T + M	4037 SFT
UNIT N	4B4T + M	4B4T + M	4060 SFT
UNIT - N1	4B4T + M	4B4T + M	4060 SFT

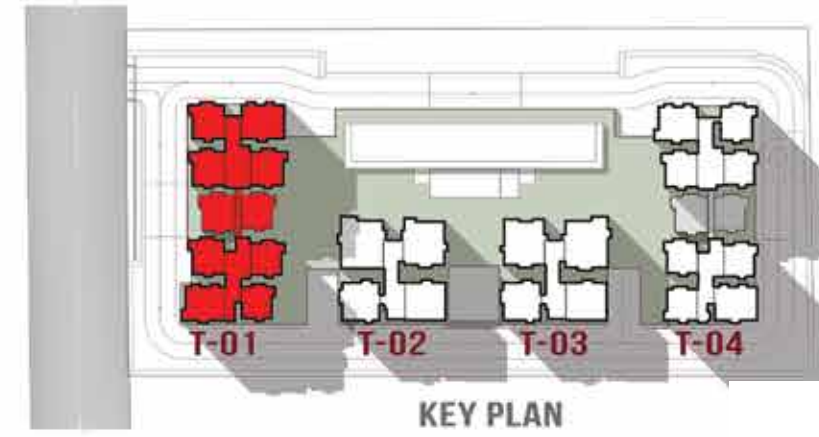

TOWER - 01 (Typical - 16th to 23rd, 25th to 33rd & 35th Floors)

LEGEND			
COLOUR	UNIT TYPE	NO. OF BED	AREA
UNIT A	3B3T	3B3T	1989 SFT
UNIT B	3B3T	3B3T	1988 SFT
UNIT C	3B3T	3B3T	2003 SFT
UNIT D	3 BHK LARGE	3 BHK LARGE	2257 SFT
UNIT E	3 BHK LARGE	3 BHK LARGE	2257 SFT
UNIT F	3B3T + S	3B3T + S	2710 SFT
UNIT G	3B3T + S + M	3B3T + S + M	2838 SFT
UNIT - G1	3B3T +S + M	3B3T +S + M	2838 SFT
UNIT H	3B3T + S	3B3T + S	2870 SFT
UNIT - H1	3B3T + S	3B3T + S	2870 SFT
UNIT J	3B3T + S + M	3B3T + S + M	2944 SFT
UNIT - J1	3B3T +S + M	3B3T +S + M	2944 SFT
UNIT K	4B4T + M	4B4T + M	3500 SFT
UNIT - K1	4B4T + M	4B4T + M	3500 SFT
UNIT L	4B4T + M	4B4T + M	3536 SFT
UNIT - L1	4B4T + M	4B4T + M	3536 SFT
UNIT M	4B4T + M	4B4T + M	4037 SFT
UNIT - M1	4B4T + M	4B4T + M	4037 SFT
UNIT N	4B4T + M	4B4T + M	4060 SFT
UNIT - N1	4B4T + M	4B4T + M	4060 SFT

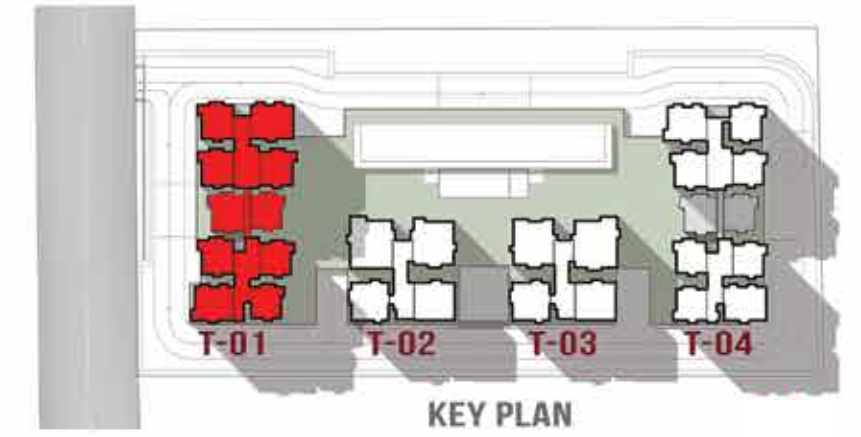

TOWER - 01 (Refuge Floor - 24th & 34th Floors)

LEGEND			
COLOUR	UNIT TYPE	NO. OF BED	AREA
UNIT A	3B3T	3B3T	1989 SFT
UNIT B	3B3T	3B3T	1988 SFT
UNIT C	3B3T	3B3T	2003 SFT
UNIT D	3 BHK LARGE	3 BHK LARGE	2257 SFT
UNIT E	3 BHK LARGE	3 BHK LARGE	2257 SFT
UNIT F	3B3T + S	3B3T + S	2710 SFT
UNIT G	3B3T + S + M	3B3T + S + M	2838 SFT
UNIT - G1	3B3T + S + M	3B3T + S + M	2838 SFT
UNIT H	3B3T + S	3B3T + S	2870 SFT
UNIT - H1	3B3T + S	3B3T + S	2870 SFT
UNIT J	3B3T + S + M	3B3T + S + M	2944 SFT
UNIT - J1	3B3T + S + M	3B3T + S + M	2944 SFT
UNIT K	4B4T + M	4B4T + M	3500 SFT
UNIT - K1	4B4T + M	4B4T + M	3500 SFT
UNIT L	4B4T + M	4B4T + M	3536 SFT
UNIT - L1	4B4T + M	4B4T + M	3536 SFT
UNIT M	4B4T + M	4B4T + M	4037 SFT
UNIT - M1	4B4T + M	4B4T + M	4037 SFT
UNIT N	4B4T + M	4B4T + M	4060 SFT
UNIT - N1	4B4T + M	4B4T + M	4060 SFT



TOWER - 01 (Typical - 36th, 37th & 38th Floors)

LEGEND			
COLOUR	UNIT TYPE	NO. OF BED	AREA
UNIT A	3B3T	3B3T	1989 SFT
UNIT B	3B3T	3B3T	1988 SFT
UNIT C	3B3T	3B3T	2003 SFT
UNIT D	3 BHK LARGE	3 BHK LARGE	2257 SFT
UNIT E	3 BHK LARGE	3 BHK LARGE	2257 SFT
UNIT F	3B3T + S	3B3T + S	2710 SFT
UNIT G	3B3T + S + M	3B3T + S + M	2838 SFT
UNIT - G1	3B3T + S + M	3B3T + S + M	2838 SFT
UNIT H	3B3T + S	3B3T + S	2870 SFT
UNIT - H1	3B3T + S	3B3T + S	2870 SFT
UNIT J	3B3T + S + M	3B3T + S + M	2944 SFT
UNIT - J1	3B3T + S + M	3B3T + S + M	2944 SFT
UNIT K	4B4T + M	4B4T + M	3500 SFT
UNIT - K1	4B4T + M	4B4T + M	3500 SFT
UNIT L	4B4T + M	4B4T + M	3536 SFT
UNIT - L1	4B4T + M	4B4T + M	3536 SFT
UNIT M	4B4T + M	4B4T + M	4037 SFT
UNIT - M1	4B4T + M	4B4T + M	4037 SFT
UNIT N	4B4T + M	4B4T + M	4060 SFT
UNIT - N1	4B4T + M	4B4T + M	4060 SFT

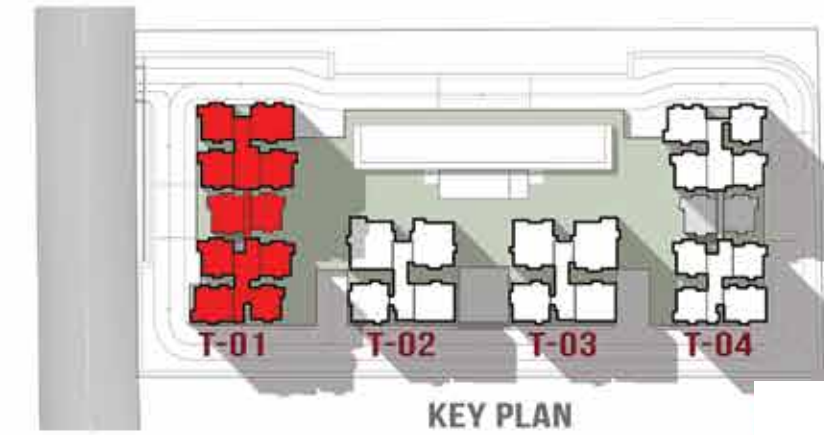
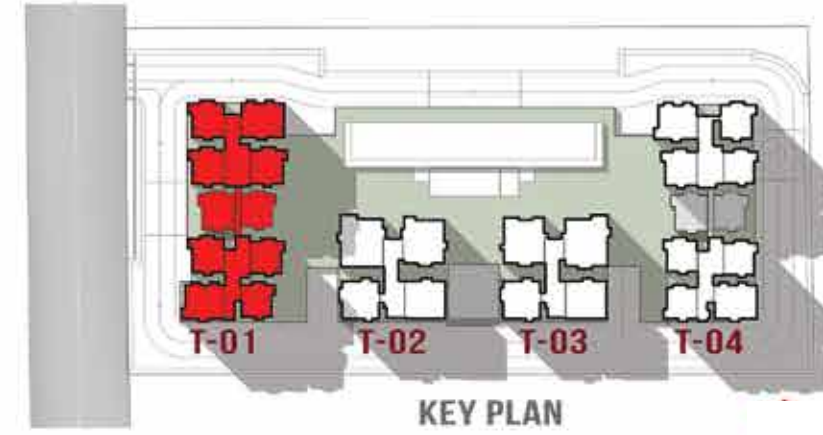

EXTERIOR VIEW



TOWER - 02 (Ground Floor Plan)

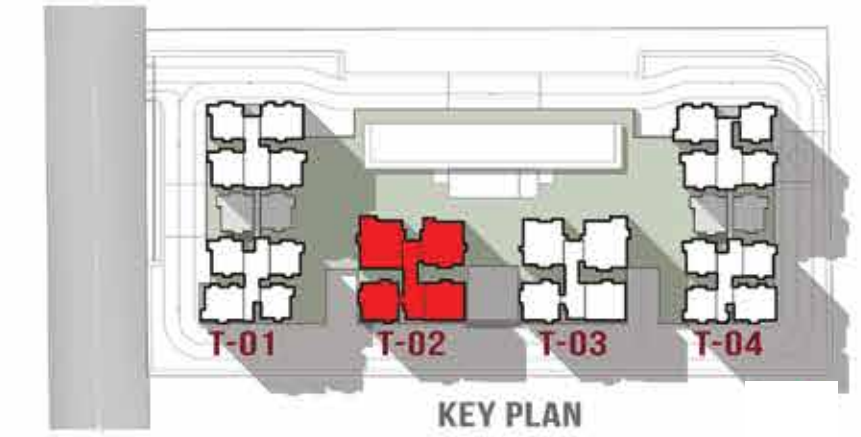

LEGEND
 01. Seating Lounge
 02. Interactive Seating

LEGEND			
COLOUR	UNIT TYPE	NO. OF BED	AREA
[Purple]	UNIT A	3B3T	1989 SFT
[Light Purple]	UNIT B	3B3T	1988 SFT
[Orange]	UNIT C	3B3T	2003 SFT
[Red]	UNIT D	3 BHK LARGE	2257 SFT
[Light Blue]	UNIT E	3 BHK LARGE	2257 SFT
[Pink]	UNIT F	3B3T + S	2710 SFT
[Light Green]	UNIT G	3B3T + S + M	2838 SFT
[Light Blue-Grey]	UNIT - G1	3B3T + S + M	2838 SFT
[Light Green]	UNIT H	3B3T + S	2870 SFT
[Light Blue-Grey]	UNIT - H1	3B3T + S	2870 SFT
[Light Green]	UNIT J	3B3T + S + M	2944 SFT
[Light Blue-Grey]	UNIT - J1	3B3T + S + M	2944 SFT
[Light Green]	UNIT K	4B4T + M	3500 SFT
[Light Green]	UNIT - K1	4B4T + M	3500 SFT
[Light Green]	UNIT L	4B4T + M	3536 SFT
[Light Green]	UNIT - L1	4B4T + M	3536 SFT
[Light Green]	UNIT M	4B4T + M	4037 SFT
[Light Green]	UNIT - M1	4B4T + M	4037 SFT
[Light Green]	UNIT N	4B4T + M	4060 SFT
[Light Green]	UNIT - N1	4B4T + M	4060 SFT

TOWER - 02 (1st & 2nd Floor Plan)

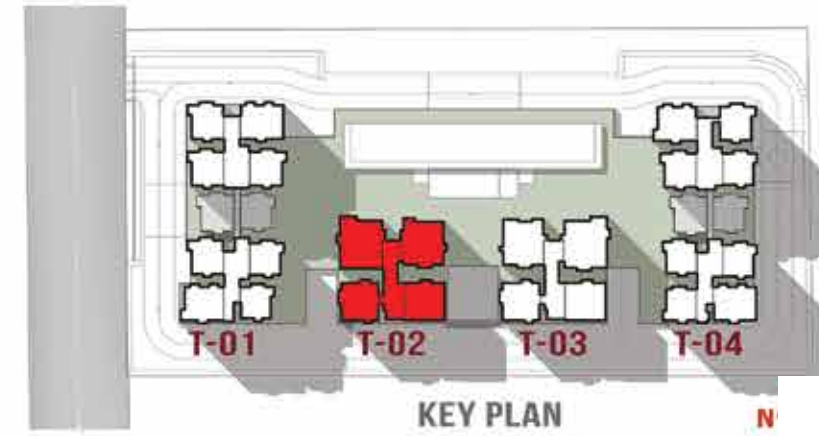
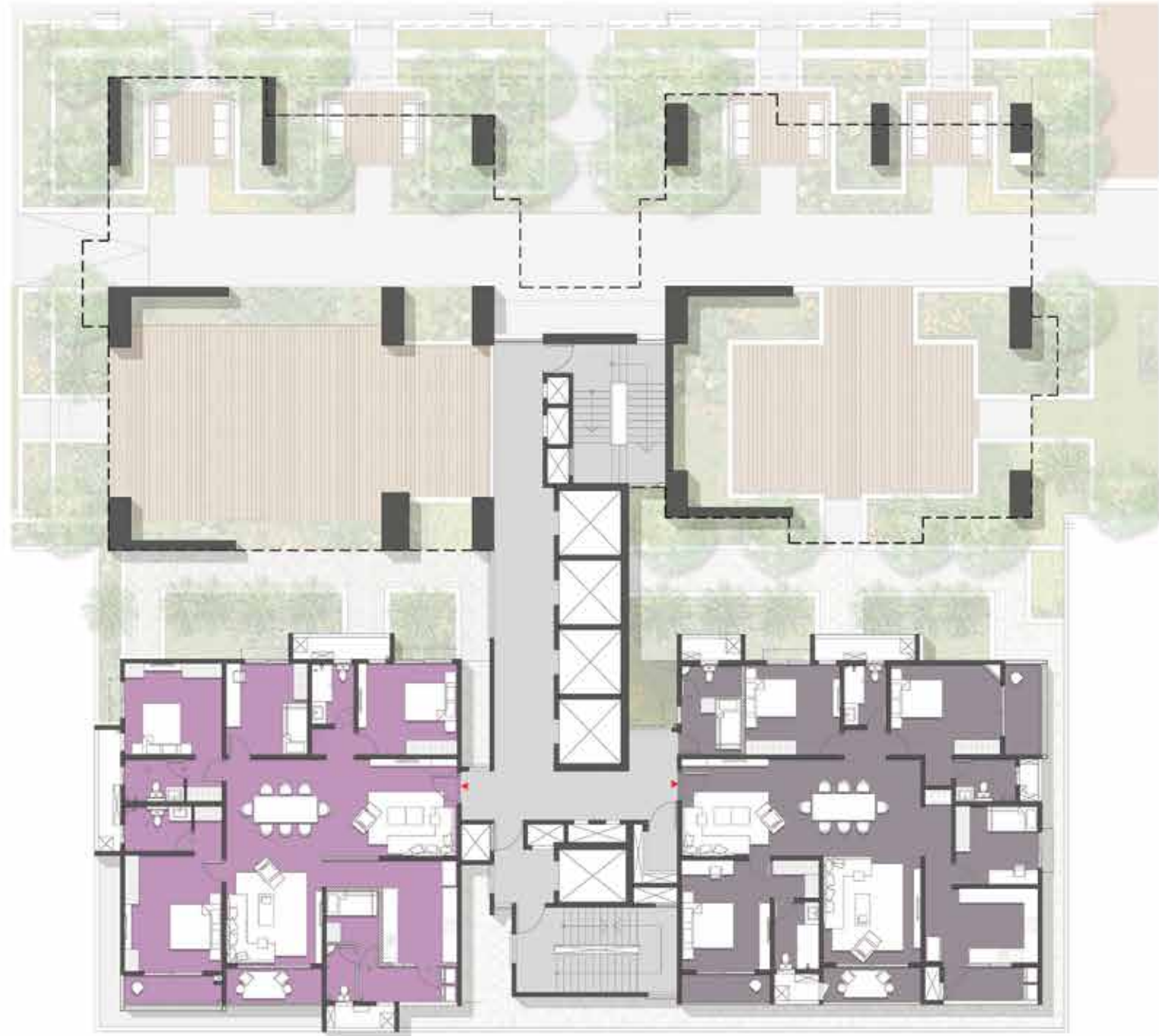

LEGEND			
COLOUR	UNIT TYPE	NO. OF BED	AREA
	UNIT A	3B3T	1989 SFT
	UNIT B	3B3T	1988 SFT
	UNIT C	3B3T	2003 SFT
	UNIT D	3 BHK LARGE	2257 SFT
	UNIT E	3 BHK LARGE	2257 SFT
	UNIT F	3B3T + S	2710 SFT
	UNIT G	3B3T + S + M	2838 SFT
	UNIT - G1	3B3T + S + M	2838 SFT
	UNIT H	3B3T + S	2870 SFT
	UNIT - H1	3B3T + S	2870 SFT
	UNIT J	3B3T + S + M	2944 SFT
	UNIT - J1	3B3T + S + M	2944 SFT
	UNIT K	4B4T + M	3500 SFT
	UNIT - K1	4B4T + M	3500 SFT
	UNIT L	4B4T + M	3536 SFT
	UNIT - L1	4B4T + M	3536 SFT
	UNIT M	4B4T + M	4037 SFT
	UNIT - M1	4B4T + M	4037 SFT
	UNIT N	4B4T + M	4060 SFT
	UNIT - N1	4B4T + M	4060 SFT

TOWER - 02 (Typical - 3rd to 11th, 13th to 20th, 22nd to 29th & 31st Floors)

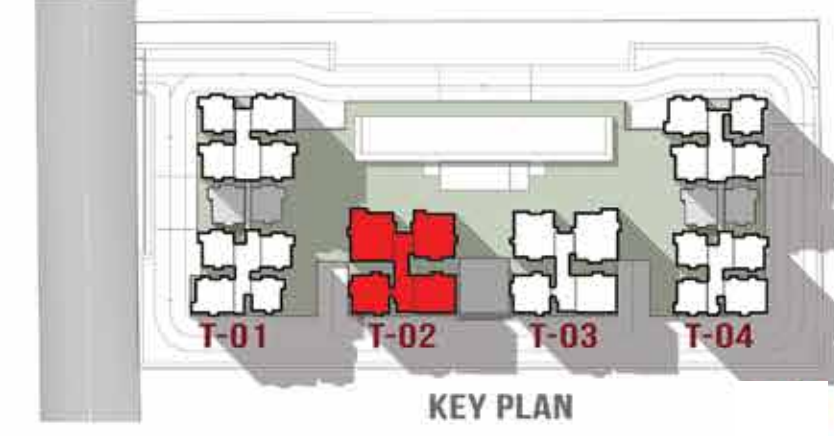

LEGEND			
COLOUR	UNIT TYPE	NO. OF BED	AREA
	UNIT A	3B3T	1989 SFT
	UNIT B	3B3T	1988 SFT
	UNIT C	3B3T	2003 SFT
	UNIT D	3 BHK LARGE	2257 SFT
	UNIT E	3 BHK LARGE	2257 SFT
	UNIT F	3B3T + S	2710 SFT
	UNIT G	3B3T + S + M	2838 SFT
	UNIT - G1	3B3T + S + M	2838 SFT
	UNIT H	3B3T + S	2870 SFT
	UNIT - H1	3B3T + S	2870 SFT
	UNIT J	3B3T + S + M	2944 SFT
	UNIT - J1	3B3T + S + M	2944 SFT
	UNIT K	4B4T + M	3500 SFT
	UNIT - K1	4B4T + M	3500 SFT
	UNIT L	4B4T + M	3536 SFT
	UNIT - L1	4B4T + M	3536 SFT
	UNIT M	4B4T + M	4037 SFT
	UNIT - M1	4B4T + M	4037 SFT
	UNIT N	4B4T + M	4060 SFT
	UNIT - N1	4B4T + M	4060 SFT

TOWER - 02 (12th, 21st & 30th Refuge Floors)

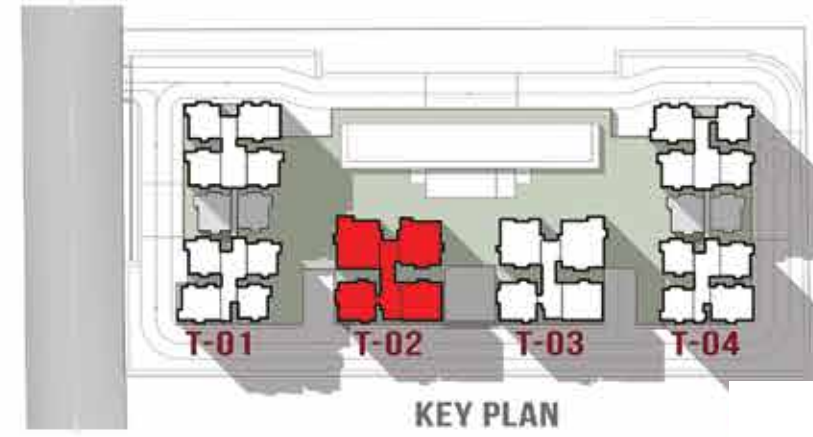

LEGEND			
COLOUR	UNIT TYPE	NO. OF BED	AREA
UNIT A	3B3T	1989 SFT	
UNIT B	3B3T	1988 SFT	
UNIT C	3B3T	2003 SFT	
UNIT D	3 BHK LARGE	2257 SFT	
UNIT E	3 BHK LARGE	2257 SFT	
UNIT F	3B3T + S	2710 SFT	
UNIT G	3B3T + S + M	2838 SFT	
UNIT - G1	3B3T + S + M	2838 SFT	
UNIT H	3B3T + S	2870 SFT	
UNIT - H1	3B3T + S	2870 SFT	
UNIT J	3B3T + S + M	2944 SFT	
UNIT - J1	3B3T + S + M	2944 SFT	
UNIT K	4B4T + M	3500 SFT	
UNIT - K1	4B4T + M	3500 SFT	
UNIT L	4B4T + M	3536 SFT	
UNIT - L1	4B4T + M	3536 SFT	
UNIT M	4B4T + M	4037 SFT	
UNIT - M1	4B4T + M	4037 SFT	
UNIT N	4B4T + M	4060 SFT	
UNIT - N1	4B4T + M	4060 SFT	

TOWER - 02 (Typical - 32nd & 33rd Floors)

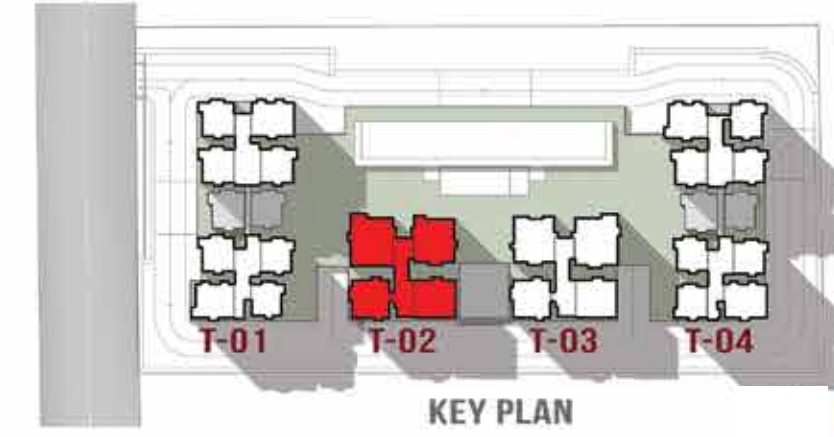

LEGEND			
COLOUR	UNIT TYPE	NO. OF BED	AREA
UNIT A	3B3T	1989 SFT	
UNIT B	3B3T	1988 SFT	
UNIT C	3B3T	2003 SFT	
UNIT D	3 BHK LARGE	2257 SFT	
UNIT E	3 BHK LARGE	2257 SFT	
UNIT F	3B3T + S	2710 SFT	
UNIT G	3B3T + S + M	2838 SFT	
UNIT - G1	3B3T + S + M	2838 SFT	
UNIT H	3B3T + S	2870 SFT	
UNIT - H1	3B3T + S	2870 SFT	
UNIT J	3B3T + S + M	2944 SFT	
UNIT - J1	3B3T + S + M	2944 SFT	
UNIT K	4B4T + M	3500 SFT	
UNIT - K1	4B4T + M	3500 SFT	
UNIT L	4B4T + M	3536 SFT	
UNIT - L1	4B4T + M	3536 SFT	
UNIT M	4B4T + M	4037 SFT	
UNIT - M1	4B4T + M	4037 SFT	
UNIT N	4B4T + M	4060 SFT	
UNIT - N1	4B4T + M	4060 SFT	

PODIUM VIEW



TOWER - 03 (Ground Floor)

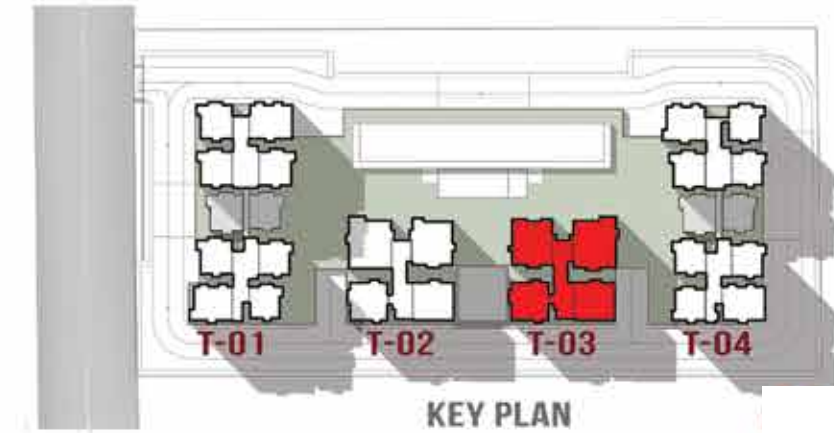

- LEGEND**
- 01. Seating Lounge
 - 02. Cafe
 - 03. Poolside Lounges

LEGEND			
COLOUR	UNIT TYPE	NO. OF BED	AREA
[Purple]	UNIT A	3B3T	1989 SFT
[Light Blue]	UNIT B	3B3T	1988 SFT
[Orange]	UNIT C	3B3T	2003 SFT
[Red]	UNIT D	3 BHK LARGE	2257 SFT
[Light Blue]	UNIT E	3 BHK LARGE	2257 SFT
[Pink]	UNIT F	3B3T + S	2710 SFT
[Purple]	UNIT G	3B3T + S + M	2838 SFT
[Brown]	UNIT - G1	3B3T+S + M	2838 SFT
[Dark Blue]	UNIT H	3B3T + S	2870 SFT
[Teal]	UNIT - H1	3B3T + S	2870 SFT
[Dark Blue]	UNIT J	3B3T + S + M	2944 SFT
[Dark Blue]	UNIT - J1	3B3T+S + M	2944 SFT
[Light Green]	UNIT K	4B4T + M	3500 SFT
[Light Green]	UNIT - K1	4B4T + M	3500 SFT
[Yellow]	UNIT L	4B4T + M	3536 SFT
[Yellow]	UNIT - L1	4B4T + M	3536 SFT
[Pink]	UNIT M	4B4T + M	4037 SFT
[Pink]	UNIT - M1	4B4T + M	4037 SFT
[Teal]	UNIT N	4B4T + M	4060 SFT
[Teal]	UNIT - N1	4B4T + M	4060 SFT

TOWER - 03 (1st & 2nd Floors)

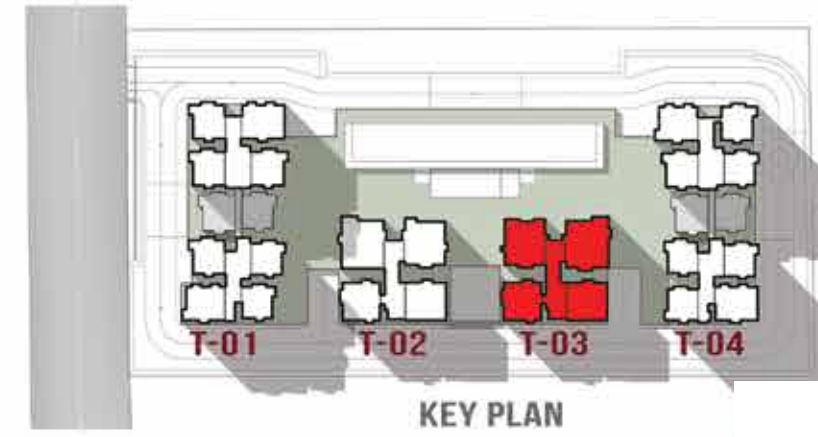
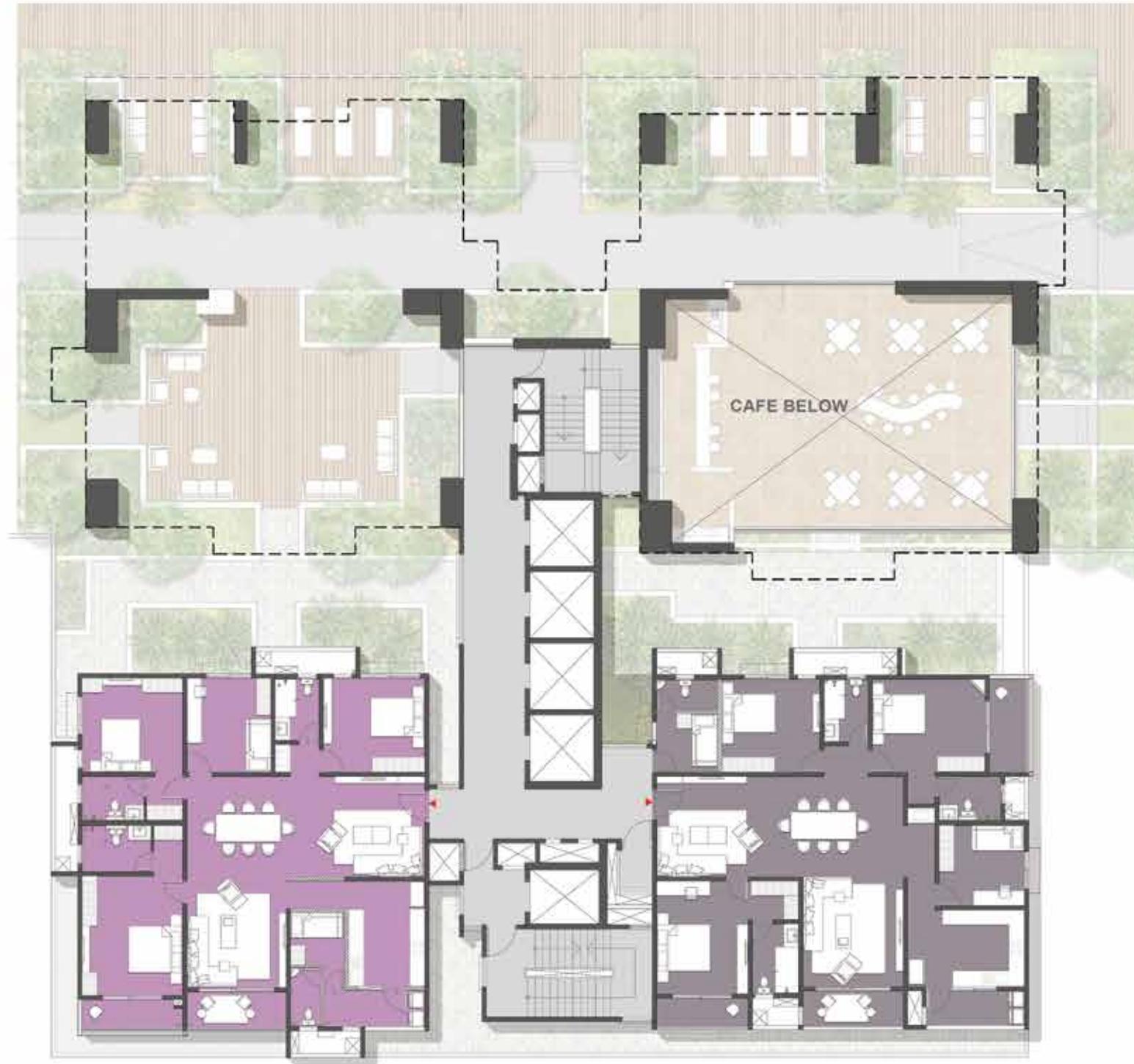

LEGEND			
COLOUR	UNIT TYPE	NO. OF BED	AREA
[Blue]	UNIT A	3B3T	1989 SFT
[Light Blue]	UNIT B	3B3T	1988 SFT
[Orange]	UNIT C	3B3T	2003 SFT
[Red]	UNIT D	3 BHK LARGE	2257 SFT
[Light Red]	UNIT E	3 BHK LARGE	2257 SFT
[Purple]	UNIT F	3B3T + S	2710 SFT
[Dark Purple]	UNIT G	3B3T + S + M	2838 SFT
[Brown]	UNIT - G1	3B3T + S + M	2838 SFT
[Dark Blue]	UNIT H	3B3T + S	2870 SFT
[Teal]	UNIT - H1	3B3T + S	2870 SFT
[Light Purple]	UNIT J	3B3T + S + M	2944 SFT
[Dark Blue]	UNIT - J1	3B3T + S + M	2944 SFT
[Light Green]	UNIT K	4B4T + M	3500 SFT
[Green]	UNIT - K1	4B4T + M	3500 SFT
[Yellow]	UNIT L	4B4T + M	3536 SFT
[Light Yellow]	UNIT - L1	4B4T + M	3536 SFT
[Pink]	UNIT M	4B4T + M	4037 SFT
[Red-Pink]	UNIT - M1	4B4T + M	4037 SFT
[Dark Green]	UNIT N	4B4T + M	4060 SFT
[Green]	UNIT - N1	4B4T + M	4060 SFT

TOWER - 03 (Typical - 3rd to 11th, 13th to 20th, 22nd to 29th & 31st Floors)

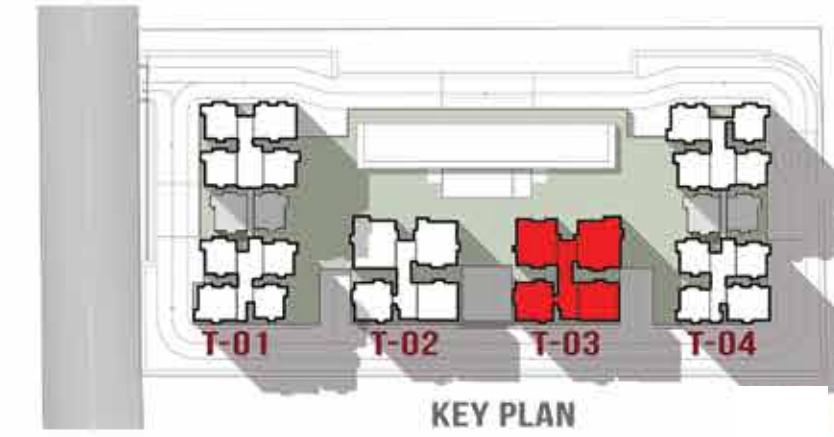

LEGEND			
COLOUR	UNIT TYPE	NO. OF BED	AREA
[Blue]	UNIT A	3B3T	1989 SFT
[Light Blue]	UNIT B	3B3T	1988 SFT
[Orange]	UNIT C	3B3T	2003 SFT
[Red]	UNIT D	3 BHK LARGE	2257 SFT
[Light Red]	UNIT E	3 BHK LARGE	2257 SFT
[Purple]	UNIT F	3B3T + S	2710 SFT
[Dark Purple]	UNIT G	3B3T + S + M	2838 SFT
[Brown]	UNIT - G1	3B3T + S + M	2838 SFT
[Dark Blue]	UNIT H	3B3T + S	2870 SFT
[Teal]	UNIT - H1	3B3T + S	2870 SFT
[Light Purple]	UNIT J	3B3T + S + M	2944 SFT
[Dark Blue]	UNIT - J1	3B3T + S + M	2944 SFT
[Light Green]	UNIT K	4B4T + M	3500 SFT
[Green]	UNIT - K1	4B4T + M	3500 SFT
[Yellow]	UNIT L	4B4T + M	3536 SFT
[Light Yellow]	UNIT - L1	4B4T + M	3536 SFT
[Pink]	UNIT M	4B4T + M	4037 SFT
[Red-Pink]	UNIT - M1	4B4T + M	4037 SFT
[Dark Green]	UNIT N	4B4T + M	4060 SFT
[Green]	UNIT - N1	4B4T + M	4060 SFT

TOWER - 03 (Typical - 32nd & 33rd Floors)

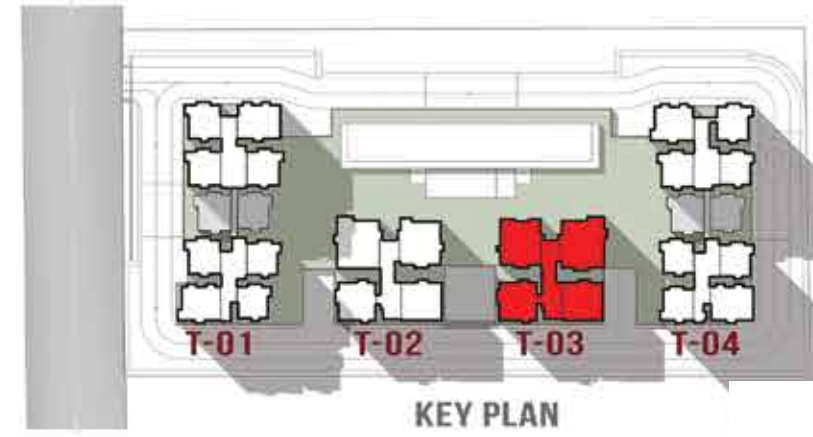
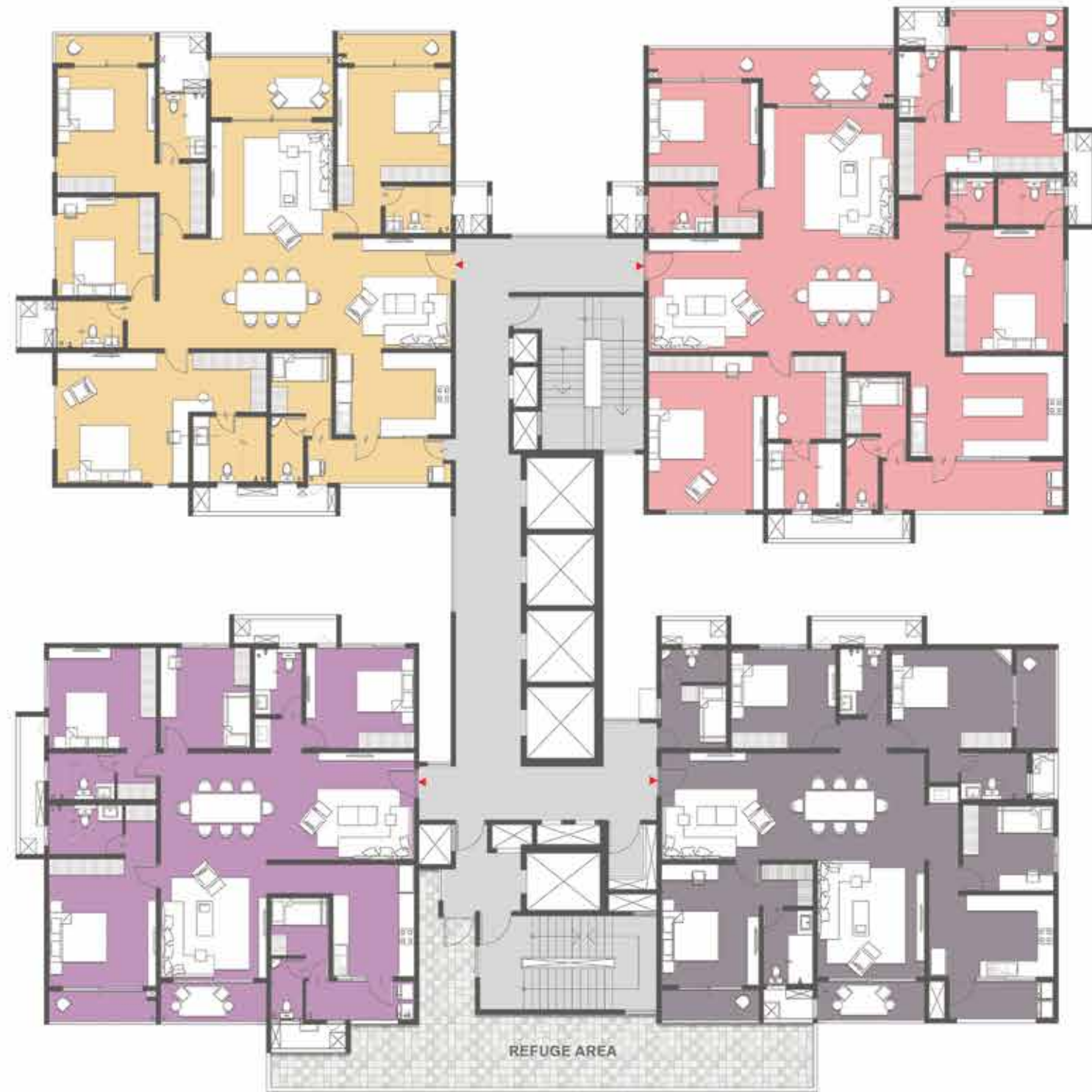

LEGEND			
COLOUR	UNIT TYPE	NO. OF BED	AREA
	UNIT A	3B3T	1989 SFT
	UNIT B	3B3T	1988 SFT
	UNIT C	3B3T	2003 SFT
	UNIT D	3 BHK LARGE	2257 SFT
	UNIT E	3 BHK LARGE	2257 SFT
	UNIT F	3B3T + S	2710 SFT
	UNIT G	3B3T + S + M	2838 SFT
	UNIT - G1	3B3T + S + M	2838 SFT
	UNIT H	3B3T + S	2870 SFT
	UNIT - H1	3B3T + S	2870 SFT
	UNIT J	3B3T + S + M	2944 SFT
	UNIT - J1	3B3T + S + M	2944 SFT
	UNIT K	4B4T + M	3500 SFT
	UNIT - K1	4B4T + M	3500 SFT
	UNIT L	4B4T + M	3536 SFT
	UNIT - L1	4B4T + M	3536 SFT
	UNIT M	4B4T + M	4037 SFT
	UNIT - M1	4B4T + M	4037 SFT
	UNIT N	4B4T + M	4060 SFT
	UNIT - N1	4B4T + M	4060 SFT

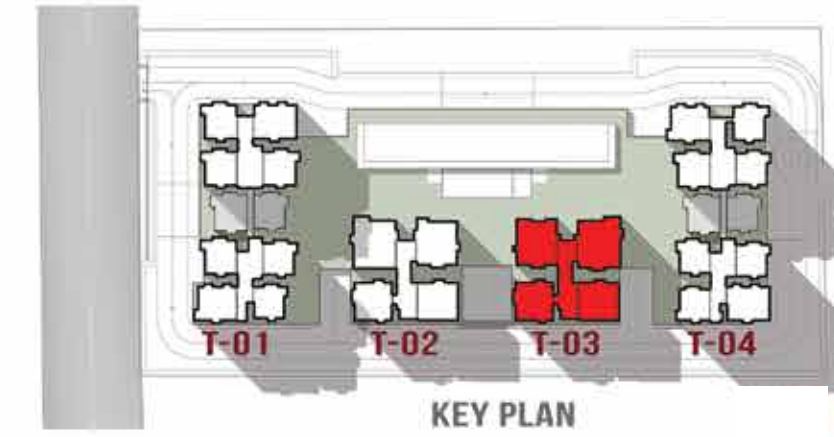

LEGEND			
COLOUR	UNIT TYPE	NO. OF BED	AREA
	UNIT A	3B3T	1989 SFT
	UNIT B	3B3T	1988 SFT
	UNIT C	3B3T	2003 SFT
	UNIT D	3 BHK LARGE	2257 SFT
	UNIT E	3 BHK LARGE	2257 SFT
	UNIT F	3B3T + S	2710 SFT
	UNIT G	3B3T + S + M	2838 SFT
	UNIT - G1	3B3T + S + M	2838 SFT
	UNIT H	3B3T + S	2870 SFT
	UNIT - H1	3B3T + S	2870 SFT
	UNIT J	3B3T + S + M	2944 SFT
	UNIT - J1	3B3T + S + M	2944 SFT
	UNIT K	4B4T + M	3500 SFT
	UNIT - K1	4B4T + M	3500 SFT
	UNIT L	4B4T + M	3536 SFT
	UNIT - L1	4B4T + M	3536 SFT
	UNIT M	4B4T + M	4037 SFT
	UNIT - M1	4B4T + M	4037 SFT
	UNIT N	4B4T + M	4060 SFT
	UNIT - N1	4B4T + M	4060 SFT

ENTRANCE LOBBY



Artist's Impression

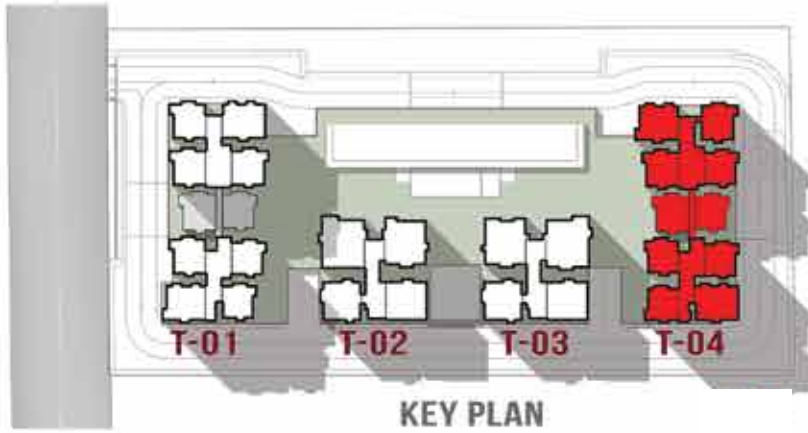

LEGEND			
COLOUR	UNIT TYPE	NO. OF BED	AREA
[Purple]	UNIT A	3B3T	1989 SFT
[Light Blue]	UNIT B	3B3T	1988 SFT
[Orange]	UNIT C	3B3T	2003 SFT
[Red]	UNIT D	3 BHK LARGE	2257 SFT
[Light Blue]	UNIT E	3 BHK LARGE	2257 SFT
[Pink]	UNIT F	3B3T + S	2710 SFT
[Purple]	UNIT G	3B3T + S + M	2838 SFT
[Brown]	UNIT - G1	3B3T + S + M	2838 SFT
[Dark Blue]	UNIT H	3B3T + S	2870 SFT
[Teal]	UNIT - H1	3B3T + S	2870 SFT
[Dark Blue]	UNIT J	3B3T + S + M	2944 SFT
[Dark Blue]	UNIT - J1	3B3T + S + M	2944 SFT
[Light Green]	UNIT K	4B4T + M	3500 SFT
[Light Green]	UNIT - K1	4B4T + M	3500 SFT
[Orange]	UNIT L	4B4T + M	3536 SFT
[Yellow]	UNIT - L1	4B4T + M	3536 SFT
[Pink]	UNIT M	4B4T + M	4037 SFT
[Pink]	UNIT - M1	4B4T + M	4037 SFT
[Teal]	UNIT N	4B4T + M	4060 SFT
[Teal]	UNIT - N1	4B4T + M	4060 SFT

LEGEND

- 01. Yoga Area
- 02. Seating Lounges

TOWER - 04 (1st & 2nd Floors)

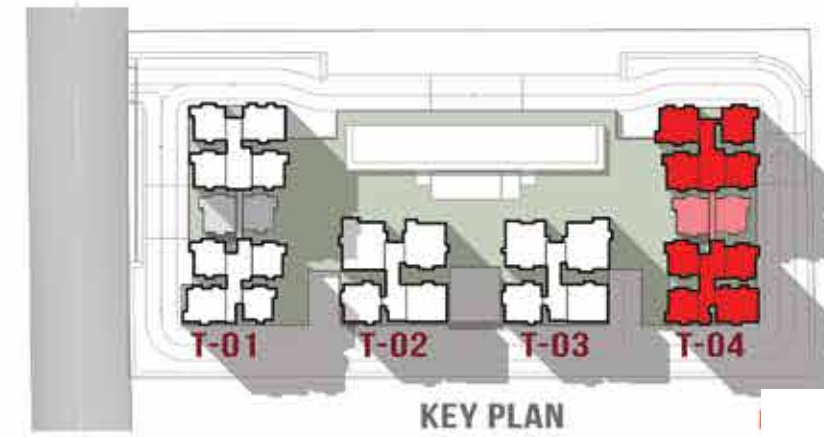

LEGEND			
COLOUR	UNIT TYPE	NO. OF BED	AREA
Blue	UNIT A	3B3T	1989 SFT
Light Blue	UNIT B	3B3T	1988 SFT
Yellow	UNIT C	3B3T	2003 SFT
Orange	UNIT D	3 BHK LARGE	2257 SFT
Light Orange	UNIT E	3 BHK LARGE	2257 SFT
Red	UNIT F	3B3T + S	2710 SFT
Purple	UNIT G	3B3T + S + M	2838 SFT
Light Purple	UNIT - G1	3B3T +S + M	2838 SFT
Dark Purple	UNIT H	3B3T + S	2870 SFT
Light Purple	UNIT - H1	3B3T + S	2870 SFT
Dark Purple	UNIT J	3B3T + S + M	2944 SFT
Light Purple	UNIT - J1	3B3T +S + M	2944 SFT
Green	UNIT K	4B4T + M	3500 SFT
Light Green	UNIT - K1	4B4T + M	3500 SFT
Yellow	UNIT L	4B4T + M	3536 SFT
Light Yellow	UNIT - L1	4B4T + M	3536 SFT
Pink	UNIT M	4B4T + M	4037 SFT
Light Pink	UNIT - M1	4B4T + M	4037 SFT
Dark Green	UNIT N	4B4T + M	4060 SFT
Light Green	UNIT - N1	4B4T + M	4060 SFT

TOWER - 04 (Typical - 3rd to 13th Floors)

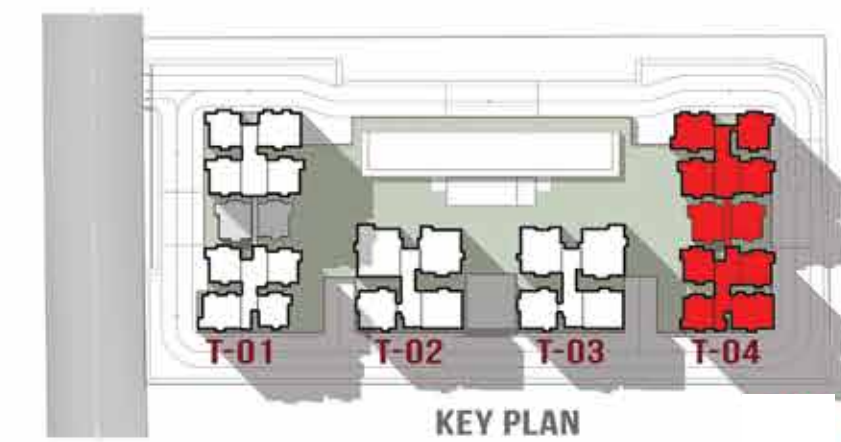

LEGEND			
COLOUR	UNIT TYPE	NO. OF BED	AREA
Blue	UNIT A	3B3T	1989 SFT
Light Blue	UNIT B	3B3T	1988 SFT
Yellow	UNIT C	3B3T	2003 SFT
Orange	UNIT D	3 BHK LARGE	2257 SFT
Light Orange	UNIT E	3 BHK LARGE	2257 SFT
Red	UNIT F	3B3T + S	2710 SFT
Purple	UNIT G	3B3T + S + M	2838 SFT
Light Purple	UNIT - G1	3B3T +S + M	2838 SFT
Dark Purple	UNIT H	3B3T + S	2870 SFT
Light Purple	UNIT - H1	3B3T + S	2870 SFT
Dark Purple	UNIT J	3B3T + S + M	2944 SFT
Light Purple	UNIT - J1	3B3T +S + M	2944 SFT
Green	UNIT K	4B4T + M	3500 SFT
Light Green	UNIT - K1	4B4T + M	3500 SFT
Yellow	UNIT L	4B4T + M	3536 SFT
Light Yellow	UNIT - L1	4B4T + M	3536 SFT
Pink	UNIT M	4B4T + M	4037 SFT
Light Pink	UNIT - M1	4B4T + M	4037 SFT
Dark Green	UNIT N	4B4T + M	4060 SFT
Light Green	UNIT - N1	4B4T + M	4060 SFT

TOWER - 04 (Refuge Floor - 14th Floor)

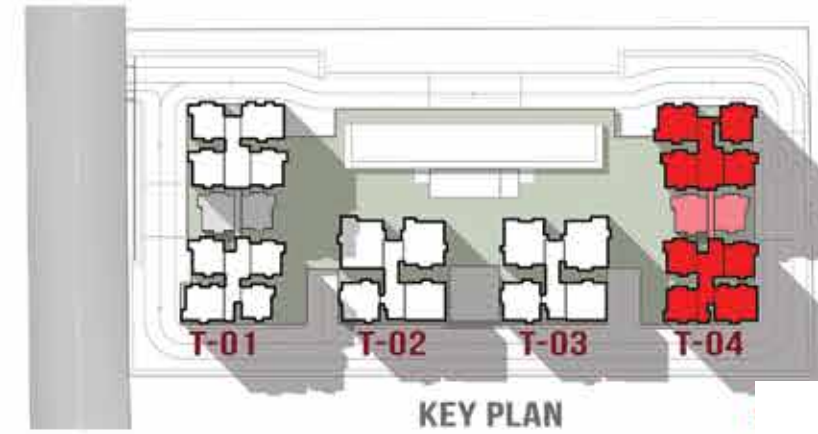

LEGEND			
COLOUR	UNIT TYPE	NO. OF BED	AREA
Blue	UNIT A	3B3T	1989 SFT
Light Blue	UNIT B	3B3T	1988 SFT
Yellow	UNIT C	3B3T	2003 SFT
Orange	UNIT D	3 BHK LARGE	2257 SFT
Light Orange	UNIT E	3 BHK LARGE	2257 SFT
Red	UNIT F	3B3T + S	2710 SFT
Purple	UNIT G	3B3T + S + M	2838 SFT
Brown	UNIT - G1	3B3T +S + M	2838 SFT
Dark Blue	UNIT H	3B3T + S	2870 SFT
Light Blue	UNIT - H1	3B3T + S	2870 SFT
Dark Purple	UNIT J	3B3T + S + M	2944 SFT
Dark Blue	UNIT - J1	3B3T +S + M	2944 SFT
Light Green	UNIT K	4B4T + M	3500 SFT
Light Green	UNIT - K1	4B4T + M	3500 SFT
Yellow	UNIT L	4B4T + M	3536 SFT
Yellow	UNIT - L1	4B4T + M	3536 SFT
Pink	UNIT M	4B4T + M	4037 SFT
Pink	UNIT - M1	4B4T + M	4037 SFT
Dark Green	UNIT N	4B4T + M	4060 SFT
Dark Green	UNIT - N1	4B4T + M	4060 SFT

TOWER - 04 (15th Floor)

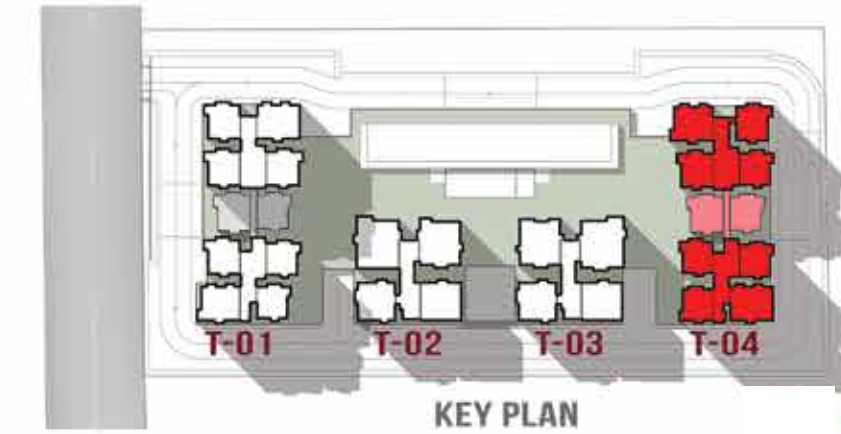

LEGEND			
COLOUR	UNIT TYPE	NO. OF BED	AREA
Blue	UNIT A	3B3T	1989 SFT
Light Blue	UNIT B	3B3T	1988 SFT
Yellow	UNIT C	3B3T	2003 SFT
Orange	UNIT D	3 BHK LARGE	2257 SFT
Light Orange	UNIT E	3 BHK LARGE	2257 SFT
Red	UNIT F	3B3T + S	2710 SFT
Purple	UNIT G	3B3T + S + M	2838 SFT
Brown	UNIT - G1	3B3T +S + M	2838 SFT
Dark Blue	UNIT H	3B3T + S	2870 SFT
Light Blue	UNIT - H1	3B3T + S	2870 SFT
Dark Purple	UNIT J	3B3T + S + M	2944 SFT
Dark Blue	UNIT - J1	3B3T +S + M	2944 SFT
Light Green	UNIT K	4B4T + M	3500 SFT
Light Green	UNIT - K1	4B4T + M	3500 SFT
Yellow	UNIT L	4B4T + M	3536 SFT
Yellow	UNIT - L1	4B4T + M	3536 SFT
Pink	UNIT M	4B4T + M	4037 SFT
Pink	UNIT - M1	4B4T + M	4037 SFT
Dark Green	UNIT N	4B4T + M	4060 SFT
Dark Green	UNIT - N1	4B4T + M	4060 SFT

TOWER - 04 (16th to 23rd, 25th to 33rd & 35th Floors)

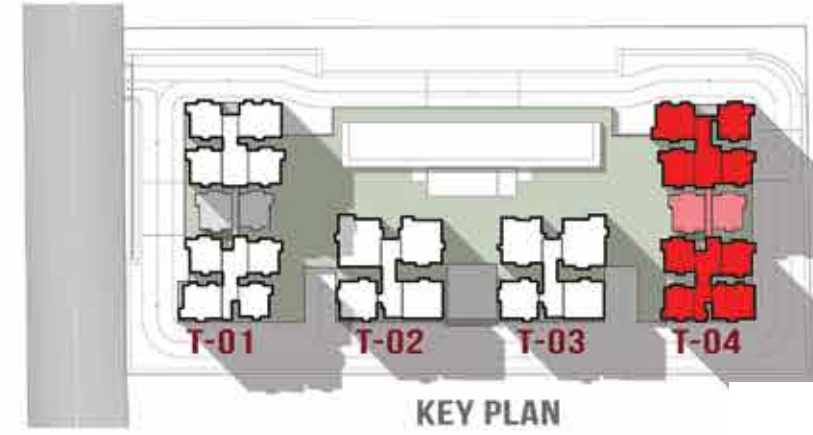

LEGEND			
COLOUR	UNIT TYPE	NO. OF BED	AREA
[Blue]	UNIT A	3B3T	1989 SFT
[Light Blue]	UNIT B	3B3T	1988 SFT
[Orange]	UNIT C	3B3T	2003 SFT
[Red]	UNIT D	3 BHK LARGE	2257 SFT
[Light Red]	UNIT E	3 BHK LARGE	2257 SFT
[Pink]	UNIT F	3B3T + S	2710 SFT
[Purple]	UNIT G	3B3T + S + M	2838 SFT
[Brown]	UNIT - G1	3B3T +S + M	2838 SFT
[Dark Blue]	UNIT H	3B3T + S	2870 SFT
[Teal]	UNIT - H1	3B3T + S	2870 SFT
[Dark Purple]	UNIT J	3B3T + S + M	2944 SFT
[Dark Blue-Black]	UNIT - J1	3B3T +S + M	2944 SFT
[Green]	UNIT K	4B4T + M	3500 SFT
[Light Green]	UNIT - K1	4B4T + M	3500 SFT
[Yellow-Orange]	UNIT L	4B4T + M	3536 SFT
[Yellow]	UNIT - L1	4B4T + M	3536 SFT
[Light Pink]	UNIT M	4B4T + M	4037 SFT
[Red-Pink]	UNIT - M1	4B4T + M	4037 SFT
[Dark Green]	UNIT N	4B4T + M	4060 SFT
[Dark Teal]	UNIT - N1	4B4T + M	4060 SFT

TOWER - 04 (Refuge Floor - 24th & 34th Floors)

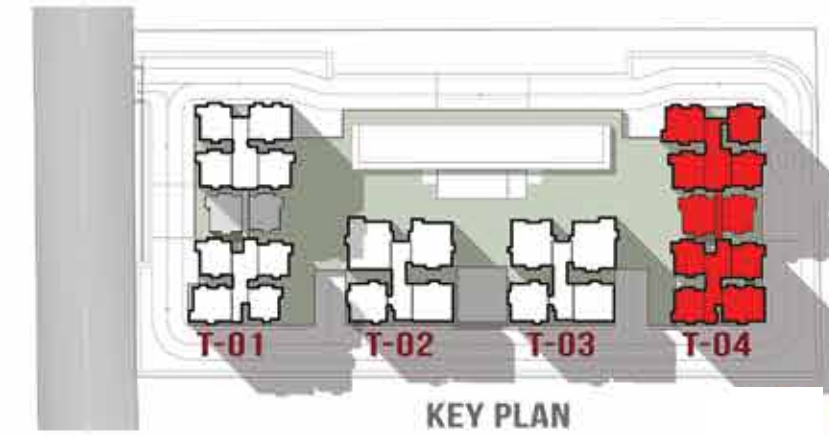

LEGEND			
COLOUR	UNIT TYPE	NO. OF BED	AREA
[Blue]	UNIT A	3B3T	1989 SFT
[Light Blue]	UNIT B	3B3T	1988 SFT
[Orange]	UNIT C	3B3T	2003 SFT
[Red]	UNIT D	3 BHK LARGE	2257 SFT
[Light Red]	UNIT E	3 BHK LARGE	2257 SFT
[Pink]	UNIT F	3B3T + S	2710 SFT
[Purple]	UNIT G	3B3T + S + M	2838 SFT
[Brown]	UNIT - G1	3B3T +S + M	2838 SFT
[Dark Blue]	UNIT H	3B3T + S	2870 SFT
[Teal]	UNIT - H1	3B3T + S	2870 SFT
[Dark Purple]	UNIT J	3B3T + S + M	2944 SFT
[Dark Blue-Black]	UNIT - J1	3B3T +S + M	2944 SFT
[Green]	UNIT K	4B4T + M	3500 SFT
[Light Green]	UNIT - K1	4B4T + M	3500 SFT
[Yellow-Orange]	UNIT L	4B4T + M	3536 SFT
[Yellow]	UNIT - L1	4B4T + M	3536 SFT
[Light Pink]	UNIT M	4B4T + M	4037 SFT
[Red-Pink]	UNIT - M1	4B4T + M	4037 SFT
[Dark Green]	UNIT N	4B4T + M	4060 SFT
[Dark Teal]	UNIT - N1	4B4T + M	4060 SFT

TOWER - 04 (36th, 37th & 38th Floors)



52

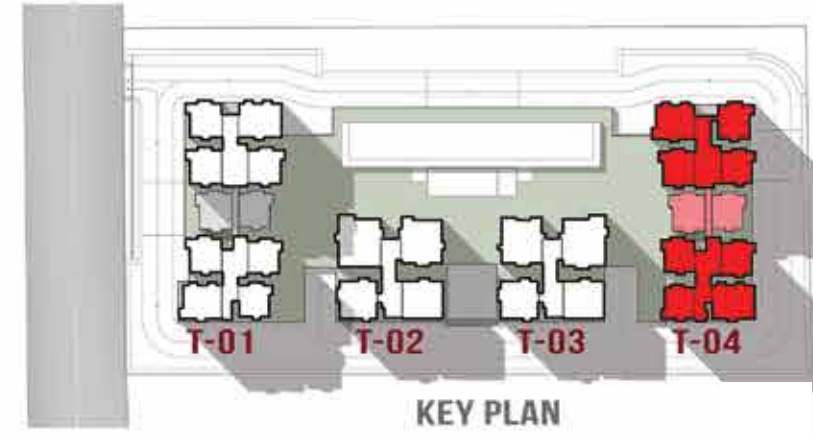

LEGEND			
COLOUR	UNIT TYPE	NO. OF BED	AREA
	UNIT A	3B3T	1989 SFT
	UNIT B	3B3T	1988 SFT
	UNIT C	3B3T	2003 SFT
	UNIT D	3 BHK LARGE	2257 SFT
	UNIT E	3 BHK LARGE	2257 SFT
	UNIT F	3B3T + S	2710 SFT
	UNIT G	3B3T + S + M	2838 SFT
	UNIT - G1	3B3T + S + M	2838 SFT
	UNIT H	3B3T + S	2870 SFT
	UNIT - H1	3B3T + S	2870 SFT
	UNIT J	3B3T + S + M	2944 SFT
	UNIT - J1	3B3T + S + M	2944 SFT
	UNIT K	4B4T + M	3500 SFT
	UNIT - K1	4B4T + M	3500 SFT
	UNIT L	4B4T + M	3536 SFT
	UNIT - L1	4B4T + M	3536 SFT
	UNIT M	4B4T + M	4037 SFT
	UNIT - M1	4B4T + M	4037 SFT
	UNIT N	4B4T + M	4060 SFT
	UNIT - N1	4B4T + M	4060 SFT

ENTRANCE LOBBY



Artist's Impression

53



BASK IN MIND BLOWING VIEWS

Neopolis is naturally located at an elevation above mean sea level. This means your home at Prestige Clairemont is perched at a height that commands spectacular vistas of the Hyderabad cityscape as well as the pristine Gandipet lake, which is a short drive away.

To take maximum advantage of this terrain, set in a site of 7.5 acres, Prestige Clairemont's four towers are judiciously spaced out and positioned so that every home faces outwards and gives you excellent views.



DINING



Artist's Impression

UNIT TYPE A: 3B3T | EAST FACING

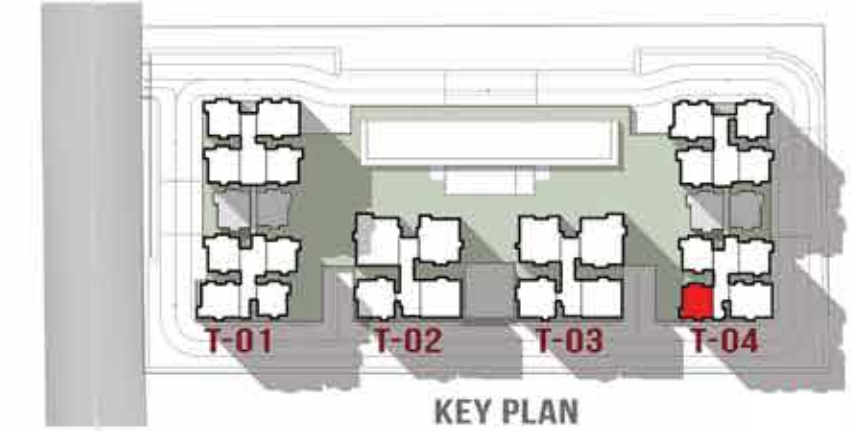

UNIT TYPE - A	
	SFT
Super Built-up Area	1989
Carpet Area	1229
Balcony / Utility	171
TOWER - 04	
Level	All the Floors

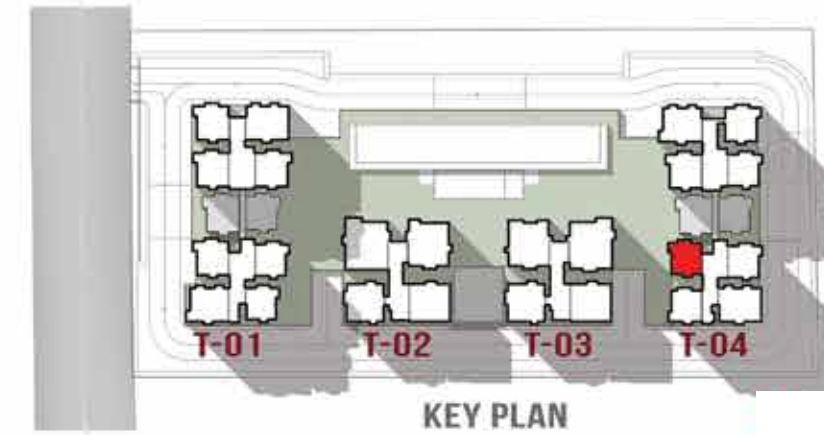

UNIT TYPE - B	
	SFT
Super Built-up Area	1988
Carpet Area	1229
Balcony / Utility	170
TOWER - 04	
Level	All the Floors

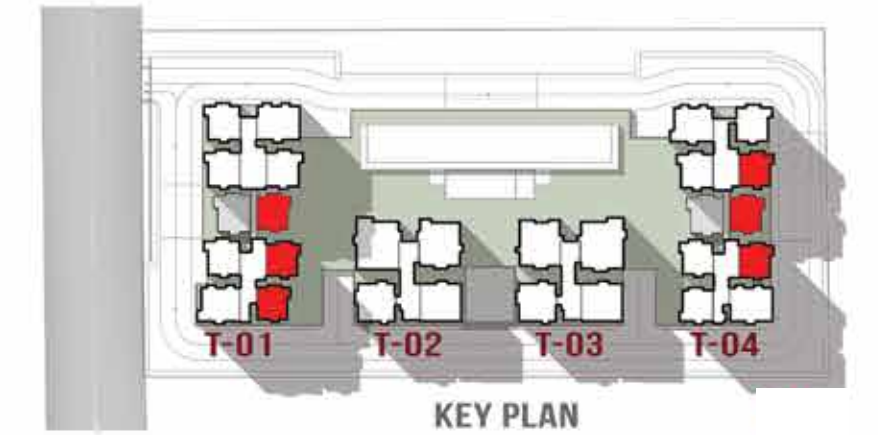

UNIT TYPE - C	
	SFT
Super Built-up Area	2003
Carpet Area	1237
Balcony / Utility	173
TOWER - 01 & 04	
Level	All the Floors

LIVING / DINING



Artist's Impression

UNIT TYPE D: 3B3T - LARGE | EAST FACING

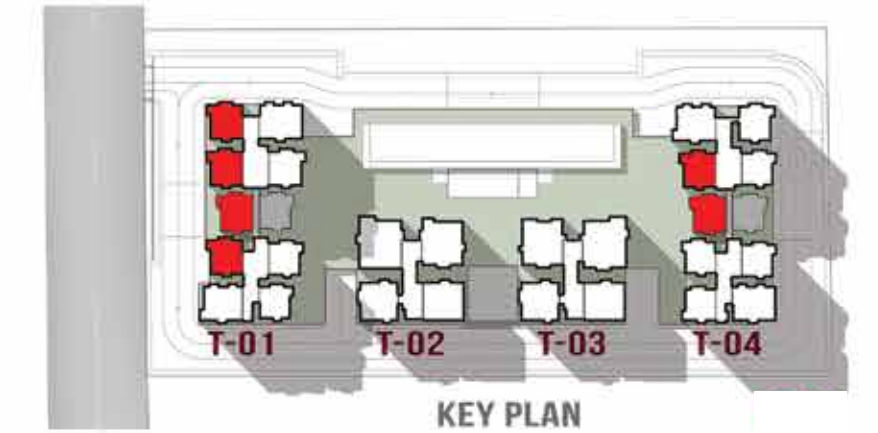

UNIT TYPE - D	
	SFT
Super Built-up Area	2257
Carpet Area	1369
Balcony / Utility	227
TOWER - 01 & 04	
Level	All the Floors

UNIT TYPE E: 3B3T - LARGE | WEST FACING

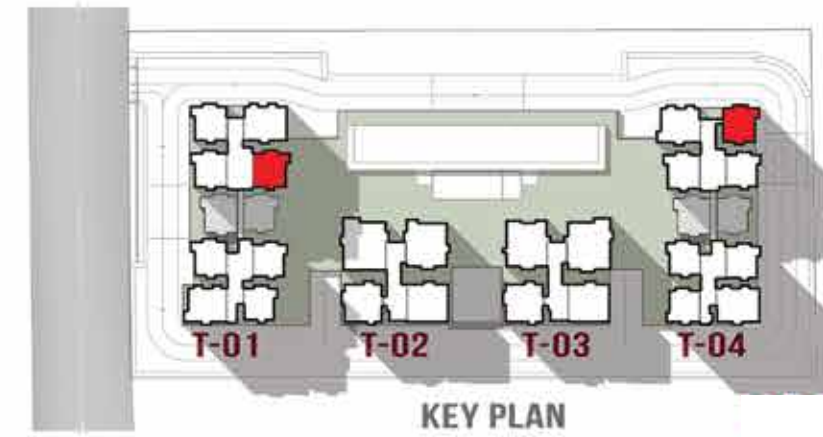

UNIT TYPE - E	
	SFT
Super Built-up Area	2257
Carpet Area	1369
Balcony / Utility	227
TOWER - 04	
Level	All the Floors

BEDROOM



UNIT TYPE F: 3B3T + S | EAST FACING

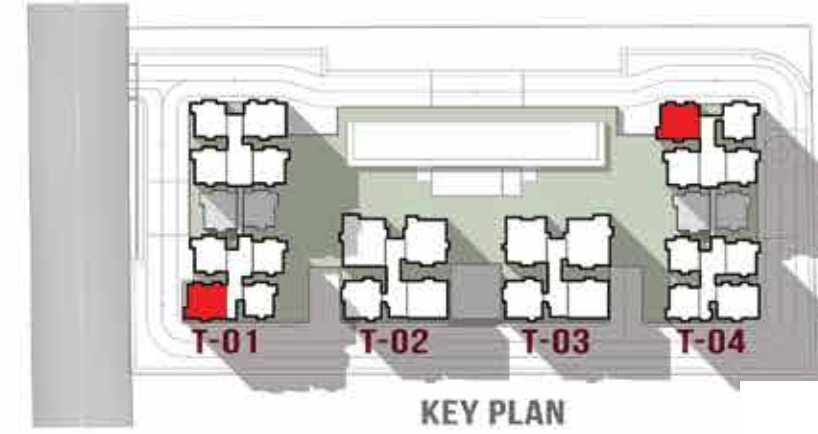

UNIT TYPE - F	
	SFT
Super Built-up Area	2710
Carpet Area	1721
Balcony / Utility	203
TOWER - 01 & 04	
Level	All the Floors

UNIT TYPE G: 3B3T + S + M | EAST FACING

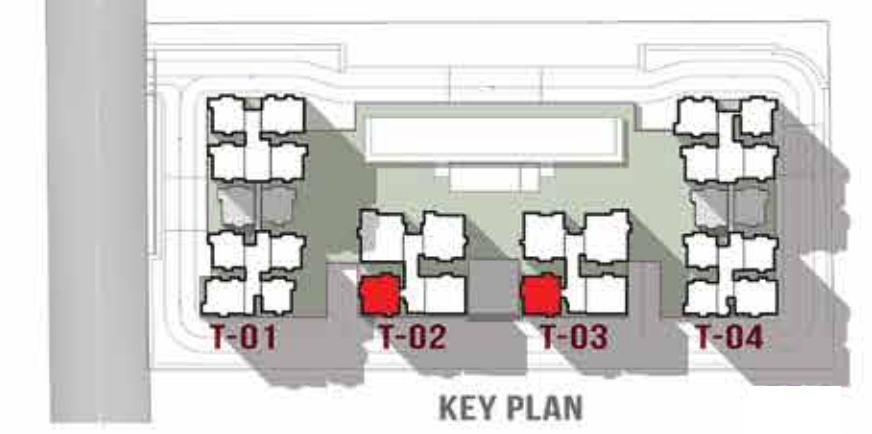

UNIT TYPE - G	
	SFT
Super Built-up Area	2838
Carpet Area	1837
Balcony / Utility	188
TOWER - 02 & 03	
Level	All the Floors

UNIT TYPE G1: 3B3T + S+M | EAST FACING

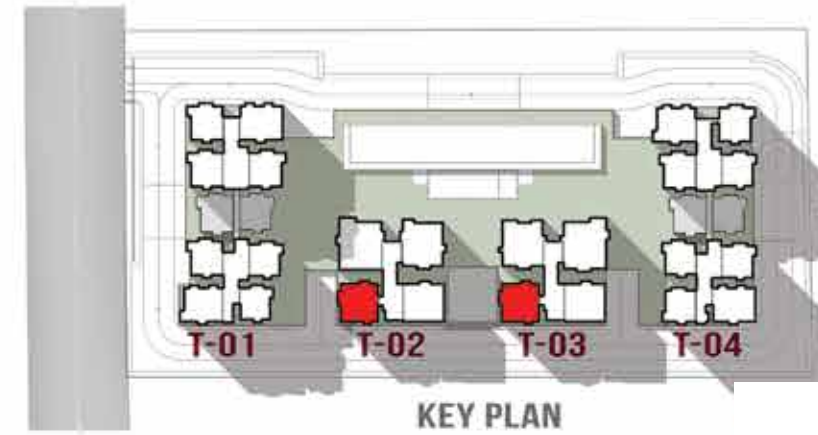

UNIT TYPE - G1	
	SFT
Super Built-up Area	2838
Carpet Area	1837
Balcony / Utility	187
TOWER - 02 & 03	
Level	32 nd & 33 rd Floors

3B3T + S | WEST FACING

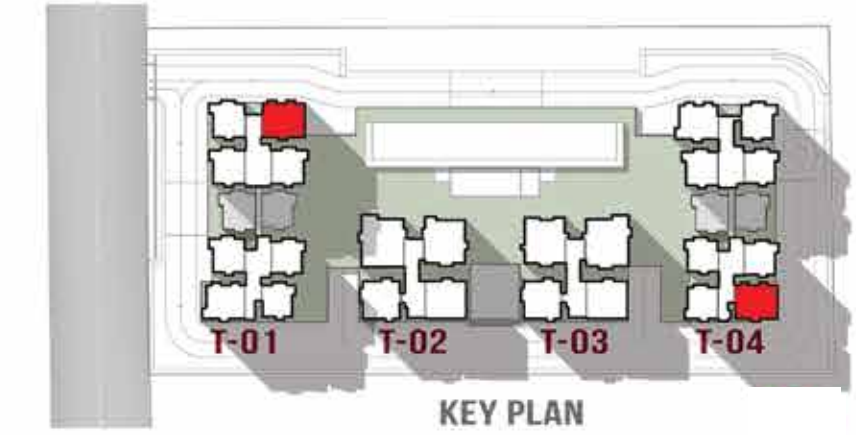

UNIT TYPE - H	
	SFT
Super Built-up Area	2870
Carpet Area	1794
Balcony / Utility	248
TOWER - 01 & 04	
Level	Ground to 35 th Floors

UNIT TYPE H1: 3B3T + S | WEST FACING

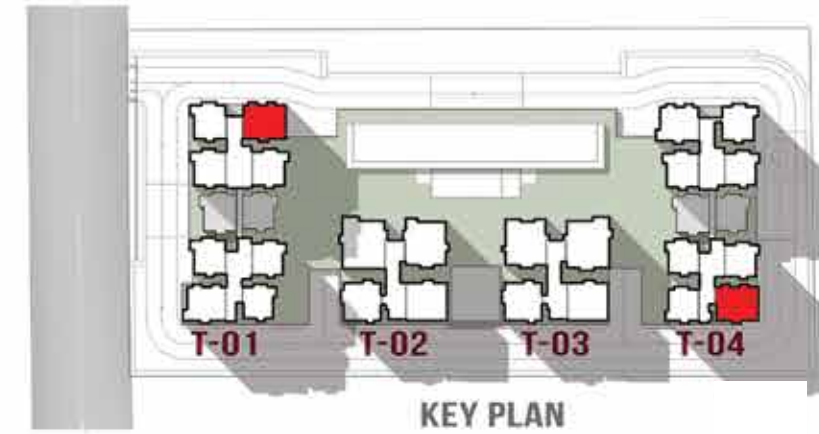

UNIT TYPE - H1	
	SFT
Super Built-up Area	2870
Carpet Area	1794
Balcony / Utility	247
TOWER - 01 & 04	
Level	36 th 37 th & 38 th Floors

UNIT TYPE J: 3B3T + S + M | WEST FACING

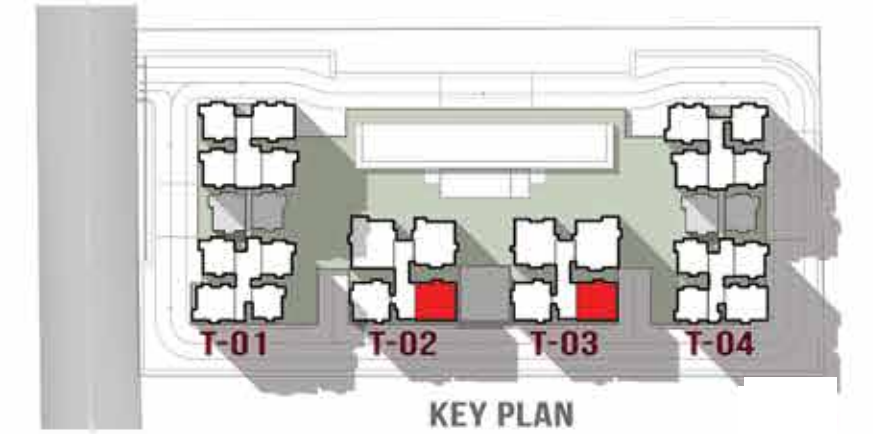

UNIT TYPE - J	
	SFT
Super Built-up Area	2944
Carpet Area	1857
Balcony / Utility	245
TOWER - 02 & 03	
Level	Ground to 31 st Floors

UNIT TYPE J1: 3B3T + S+M | WEST FACING

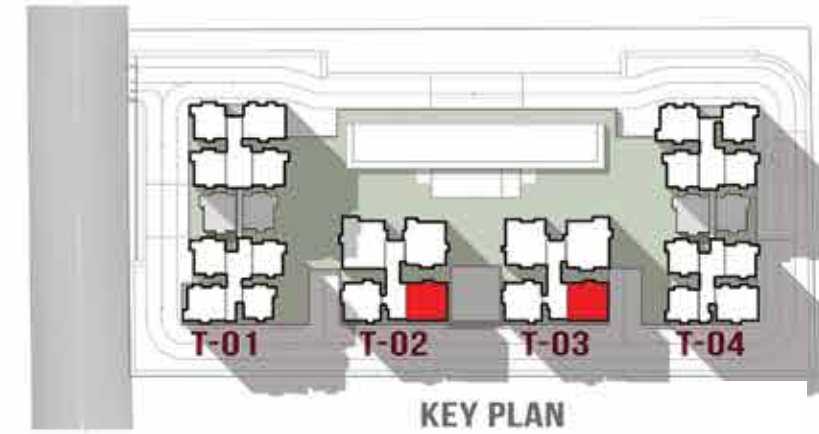

UNIT TYPE - J1	
	SFT
Super Built-up Area	2944
Carpet Area	1857
Balcony / Utility	245
TOWER - 02 & 03	
Level	32 nd & 33 rd Floors

KITCHEN



Artist's Impression

UNIT TYPE K : 4B4T + M | WEST FACING

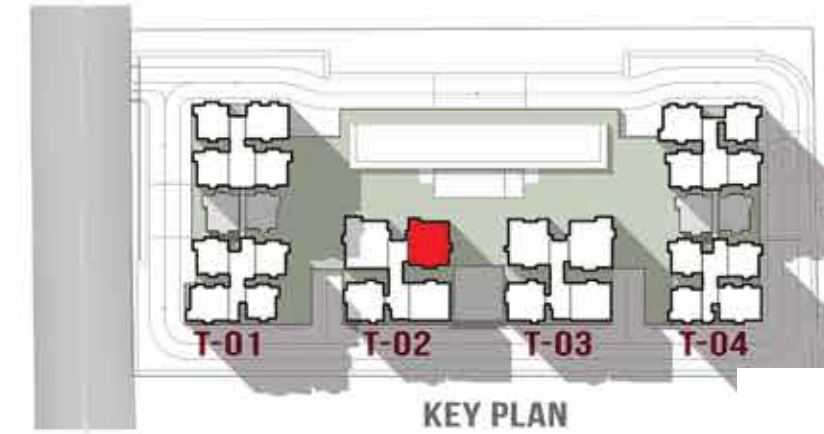

UNIT TYPE - K	
	SFT
Super Built-up Area	3500
Carpet Area	2193
Balcony / Utility	317
TOWER - 02	
Level	3 rd to 31 st floors

UNIT TYPE K1 : 4B4T + M | WEST FACING

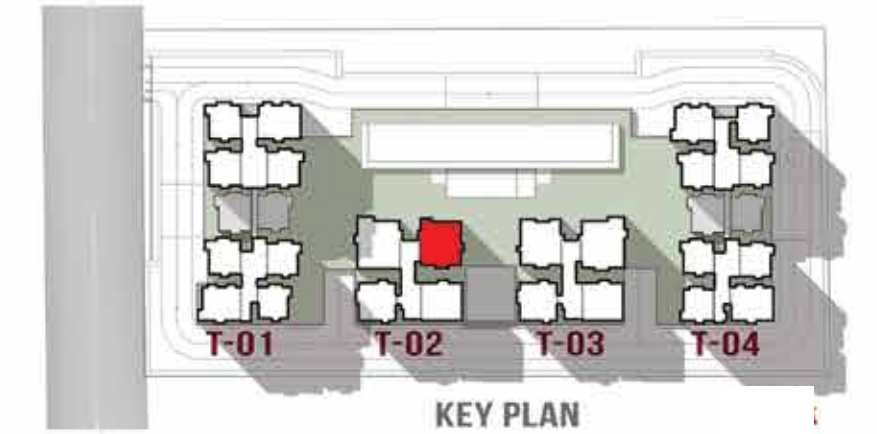

UNIT TYPE - K1	
	SFT
Super Built-up Area	3500
Carpet Area	2193
Balcony / Utility	315
TOWER - 02	
Level	32 nd to 33 rd floors

UNIT TYPE L: 4B4T + M | EAST FACING

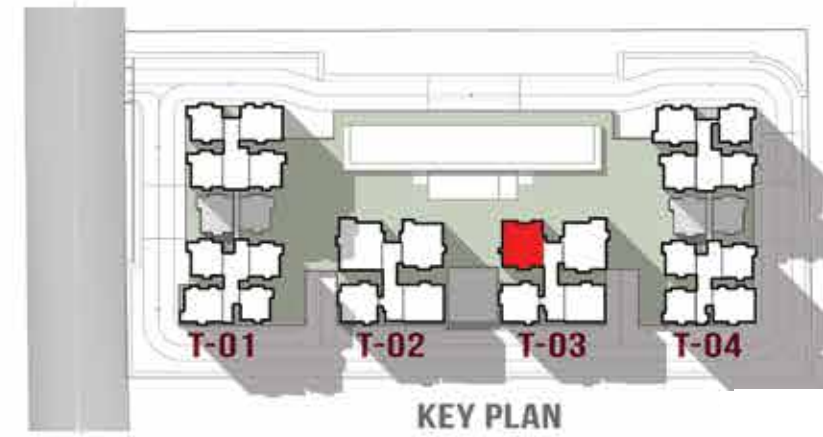

UNIT TYPE - L	
	SFT
Super Built-up Area	3536
Carpet Area	2213
Balcony / Utility	320
TOWER - 03	
Level	3 rd To 31 st Floors

UNIT TYPE L1: 4B4T + M | EAST FACING

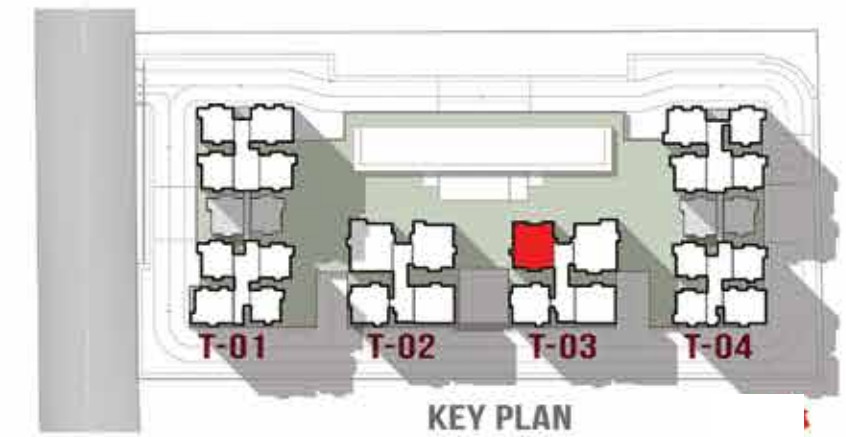

UNIT TYPE - L1	
	SFT
Super Built-up Area	3536
Carpet Area	2213
Balcony / Utility	318
TOWER - 03	
Level	32 nd to 33 rd floors

NIGHT VIEW



Artist's Impression

UNIT TYPE M: 4B4T + M | WEST FACING

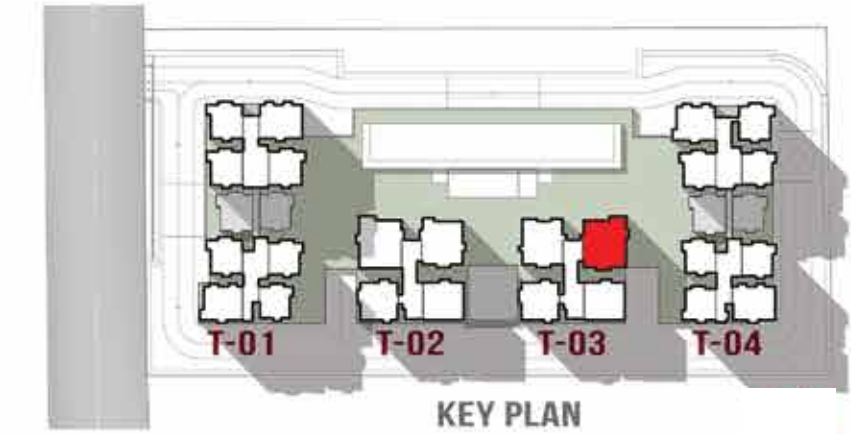

UNIT TYPE - M	
	SFT
Super Built-up Area	4037
Carpet Area	2530
Balcony / Utility	376
TOWER - 03	
Level	3 rd To 31 st Floors

UNIT TYPE M1: 4B4T + M | WEST FACING

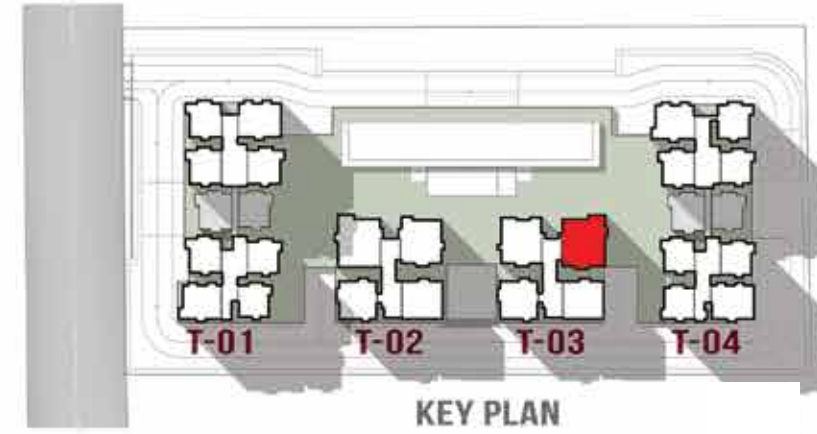

UNIT TYPE - M1	
	SFT
Super Built-up Area	4037
Carpet Area	2530
Balcony / Utility	375
TOWER - 03	
Level	32 nd To 33 rd Floors

UNIT TYPE N: 4B4T + M | EAST FACING

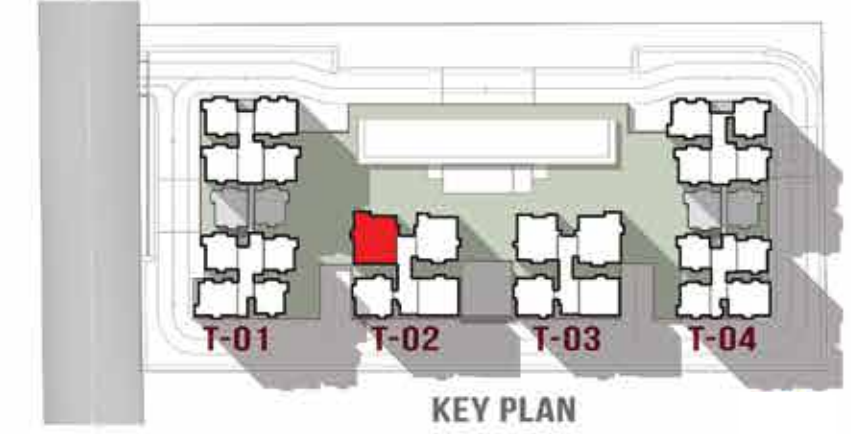

UNIT TYPE - N	
	SFT
Super Built-up Area	4060
Carpet Area	2517
Balcony / Utility	404
TOWER - 02	
Level	3 rd To 31 st Floors

UNIT TYPE N1: 4B4T + M | EAST FACING

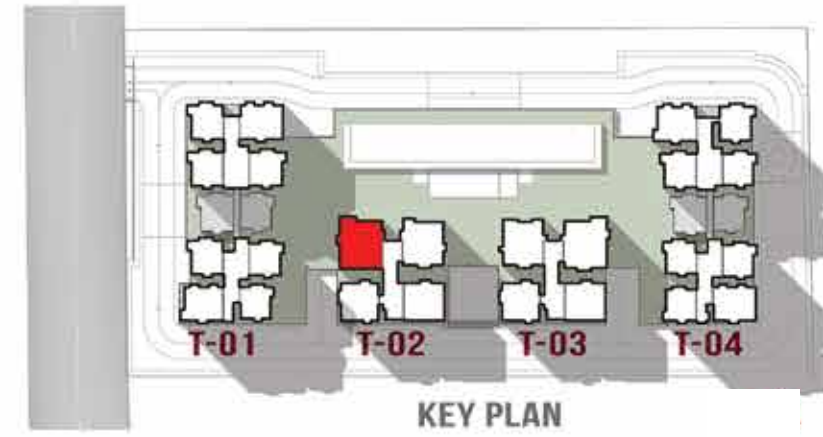

UNIT TYPE - N	
	SFT
Super Built-up Area	4060
Carpet Area	2517
Balcony / Utility	405
TOWER - 02	
Level	32 nd To 33 rd Floors





PLAY OR CHILL, AS YOU WILL!

Do your thing or do nothing. What your mood dictates is what life will be at Prestige Clairemont.

The myriad leisure amenities including a swimming pool, a tennis court, a basketball court, indoor games such as badminton, table tennis, pool, snooker, mini theatre, a party hall, a well-equipped gym, and such, offer you plenty of options to stay fit, occupied and entertained. If you are in the mood to just lean back, put your feet up and chill, you will find plenty of spaces to do that too.

In the end, it is about doing what you want to, in the manner that you are accustomed to. Exactly how you have always imagined life to be.

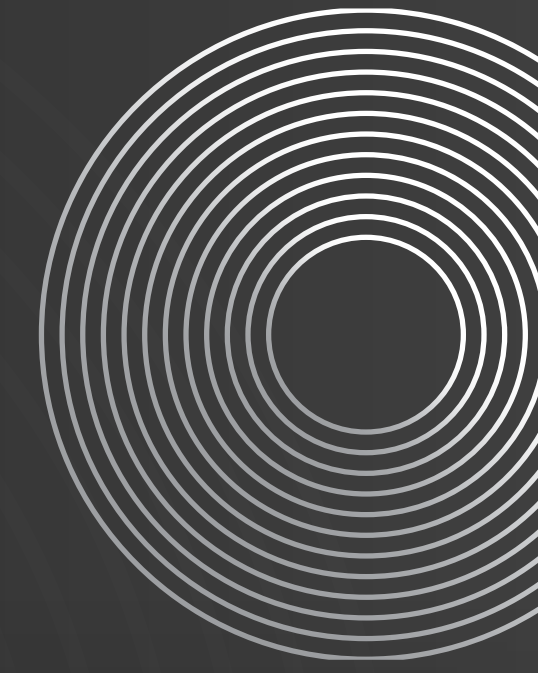

LIVE THE GOOD LIFE THAT IS GOOD FOR THE PLANET TOO

Living well and living responsibly go hand in hand at Prestige Clairemont, as sustainability is seamlessly woven into its design.

Water is conserved using a comprehensive rainwater harvesting system and a sewage treatment plant, from which treated water is used to irrigate the landscaped garden.

The ample, expansive green landscaping helps keep the air pure and the temperatures down, while the juxtapositioning of the towers maximises natural light and ventilation thereby bringing down the power demand as well.



SPECIFICATIONS

STRUCTURE

- RCC Structure in shear wall technology

LOBBY & STAIR CASE

- Elegant lobby flooring in the ground floor.
- Basement and all upper floor lobbies flooring in vitrified tiles.
- Lift cladding in granite as per architect's design.
- Service staircase and service lobby in Kota Stone, granite or cement tiles on treads.
- All lobby walls will be finished with a combination of textured paint and distemper.

LIFTS

- Lifts of suitable size and capacity will be provided in all towers.

APARTMENT FLOORING

- Vitrified tiles in the foyer, living area, dining area, corridors and all bedrooms.
- Ceramic tiles in the balcony.

KITCHEN

- Ceramic / Vitrified tiles in the kitchen, utility, maid's room and maid's toilet.
- Provision for exhaust fan.

TOILETS

- Ceramic / Vitrified tiles for floor and walls up to false ceiling.
- Toilets with wash basins on granite counter.
- EWCs with chrome plated fittings.
- CP fitting with shower mixer.
- Geysers in all toilets and instant geysers in maid's toilet.
- Suspended pipeline in all toilets concealed within a false ceiling.
- Provision for exhaust fan.

DOORS

- Main Doors - Timber and laminated flush shutters.
- Internal Doors - Wooden frames and laminated flush shutters.

EXTERNAL DOORS AND WINDOWS

- UPVC or aluminium frames and shutters for all external doors or a combination of both where required.
- UPVC or aluminium framed windows with clear glass.

PAINTING

- External emulsion on exterior walls.
- OBD on internal walls and ceiling.

ELECTRICAL

- All electrical wiring is concealed PVC insulated copper wire with modular switches.
- Sufficient power outlets and light points provided.
- ELCB and individual meters will be provided for all apartments.

TELECOMMUNICATION, TV & DATA

- TV points provided in the living area and all bedrooms.
- Telephone and data points provided in the living area and master bedroom/study

SECURITY SYSTEM

- Security cabins at all entrances and exits with CCTV coverage.

DG POWER

- 100% power back up in common areas.

AT ADDITIONAL COST

- DG POWER - 100% backup for all apartments at additional cost.

FREQUENTLY ASKED QUESTIONS

1. What is Prestige Clairemont and where is it located?

Prestige Clairemont is set to become the newest landmark in NEOPOLIS layout at Kokapet, developed by the Prestige Group. This apartment community is a perfect place for those who seek a lifestyle of opulence, a beautifully planned enclave with a combination of three and four-bedroom high-rise homes. NEOPOLIS is Hyderabad's upcoming high-rise SEZ zone offering Offices, Retail, Hotels, Entertainment and Healthcare developments next to Financial District, Gachibowli-Hyderabad.

2. What is the extent of the project land?

Over an expansive 7.56 acres of land, this project comprises 928 spacious and well-laid apartments in four towers. These high-rise towers go up to 34 and 39 levels placed over 4 levels of podium parking above the ground and 2 levels in the basement.

3. What are the distinct advantages or the USPs of Prestige Clairemont?

The project is located in the heart of the booming western corridor of Hyderabad which is a promising location surrounded by commercial hubs with excellent road connectivity, wide road network, and better civic infrastructure planning. It is also an extension of the current CBD area (Financial District, Gachibowli).

Distance from key locations

CBD Area (Financial District, Gachibowli) - 5mins drive
ORR - 2mins drive
Rajiv Gandhi International Airport - 25mins drive

SCHOOLS

Phoenix Greens, Global Edge, Rock Well, Future Kids, Keystones, Gaudium.

HOSPITALS

Continental Hospital, AIG Hospital, Care Hospital, Sunshine Hospital

SHOPPING & ENTERTAINMENT

Inorbit Mall, Preston Mall, Sarath City Capital Mall and IKEA

BUSINESS & IT PARKS

Prestige Skytech, GAR Laxmi Infobahn, Microsoft, Waverock SEZ, Amazon, Google, ICICI, Wipro, Capgemini, Cognizant, etc.

4. Who are the architects/master planners of Prestige Clairemont?

Zachariah Consultants, are the architects.

5. What are the different types and sizes of apartments?
Apartment Configuration:

Unit Details			
No. of BRs	Sale Area Sft	Carpet Area Sft	Nos
3B3T - A	1989	1229	39
3B3T - B	1988	1229	39
3B3T - C	2003	1237	178
3B3T LARGE - D	2257	1369	178
3B3T LARGE - E	2257	1369	78
3B3T+S - F	2710	1721	78
3B3T+S+M - G	2838	1837	64
3B3T +S + M - G1	2838	1837	4
3B3T+S - H	2870	1794	72
3B3T + S - H1	2870	1794	6
3B3T+S+M - J	2944	1857	64
3B3T +S + M - J1	2944	1857	4
4B4T+M - K	3500	2193	29
4B4T + M - K1	3500	2193	2
4B4T+M - L	3536	2213	29
4B4T + M - L1	3536	2213	2
4B4T+M - M	4037	2530	29
4B4T + M - M1	4037	2530	2
4B4T+M - N	4060	2517	29
4B4T + M - N1	4060	2517	2
Total Number Of Units			928

Note: Carpet area does not include balcony and utility area.

6. Is there a clubhouse and what are the amenities provided in Prestige Clairemont?

The development is complemented by the fully equipped clubhouse, which includes a swimming pool, gym, health club, party hall, pharmacy, clinic, salon, spill out area, indoor badminton court,

FREQUENTLY ASKED QUESTIONS

squash court, banquet hall, convenience store, crèche, basketball court, lawn tennis, outdoor gym, net cricket pitch, billiards, mini theatre and indoor games room.

7. Is this a phased development and what are the time lines for completion?

Prestige Clairemont is a single phase development and is scheduled for completion by June 2026 with a grace period 6 months.

8. What about car parking space?

We shall provide two car parking spaces for units up to 3000 Sq.Ft and three car parks for units above 3001 Sq.Ft. Additional car parking requests will be taken up toward project completion.

9. Is there any differential price based on the floor and orientation of the apartments?

Yes, there is a differential pricing for apartments. For every floor rise there is an increase. In addition to the floor rise, selected apartments will also attract a preferential location charge (PLC).

10. How do I book my home at Prestige Clairemont?

- Please identify your apartment from the available options.
- Fill in the booking application form and provide your KYC documents.
- Pay the initial booking amount of 10% by way of cheque/DD favouring "Prestige Estates Projects Limited, together with required supporting documents.

11. When do I get a confirmed allotment?

On payment of 10% of the sale value and submission of all KYC documents, the allotment will be confirmed.

12. What happens thereafter?

On realization of the initial payment of 10% you will be required to issue post-dated cheques (PDCs) for the instalments within 15 days against which a formal letter of allotment will be issued. Agreements will follow after completion of allotment process.

13. How are instalments to be paid and is it time bound?

Instalments are to be paid by way of post-dated cheques which is a pre-condition of the allotment. This schedule of payment is on a time bound basis as mentioned in the payment schedule. In case of a home loan, these PDCs are held with us as collateral and returned at the time of possession.

14. What happens if I cancel my booking?

Why would you want to miss out on such a strategically located and meticulously designed project? However, if you do wish to cancel after booking, 2% of the sale value will be forfeited if you cancel before the Agreements are executed and 10% of the sale value will be forfeited if you cancel after the Agreements are executed as a cancellation fee and the balance will be returned (subject to statutory deductions) without interest.

Kindly Note:

- 1) Cancellation will attract GST as applicable.
- 2) 5% GST paid on installment towards the flat will not be refunded.

15. Are modifications permitted in the apartment?

The specifications and designs have been carefully worked out. Considering the shear wall technology being adopted, no modifications are permitted.

16. Is the title of the property clear?

Legal due diligence has been done. The land is freehold, marketable and free from all encumbrances. Most importantly this is an allotment from HMDA (Government of Telangana)

17. Who is the plan sanctioning authority?

The development plans have been sanctioned by HMDA.

18. Has RERA approved this Project?

Yes, RERA Registration number - P02400005677

19. What are the documents that need to be signed?

The documents that need to be signed are Agreement to Sell, followed by a Sale Deed upon completion of the development.

20. What is the process of registration and when does registration take place?

Registration will be done only on completion of the development and on payment of the entire sale consideration including the additional charges.

21. Has Prestige Clairemont been approved by banks/housing finance institutions (HFIs) for loans?

Yes we have selected Banks/HFIs who will extend loans to customers based on their eligibility criteria.

FREQUENTLY ASKED QUESTIONS

22. What is the process of Assignment?

Assignment, subject to the discretion of Prestige, can be done only after the Agreements have been signed, PDCs given, 5 instalments paid and the new party complies with the terms and conditions of the Principal Agreement. Transfer fee of Rs.200/- per sq. ft plus GST, as applicable, will be levied. If you have availed of a loan then you will be required to retrieve and hand over all letters and documents issued by Prestige to the bank / housing finance institution along with loan closure letter. Please note that transfer will be done only when there are no dues and stamp duty and registration charges, if applicable, have been paid

23. What if Prestige delays the construction and possession?

Our endeavour is to complete and hand over the project as per committed time lines. However, for reasons beyond our control if the project is delayed, Prestige will pay compensation* as per RERA guidelines set by Telangana government.

24. What are the additional amounts to be paid?

HMWSSB/TRANSC charges, GST, Generator charges, Registration & Stamp duty charges, Sinking fund & Advance maintenance and any other statutory charges/ duties as applicable. GST will be collected along with booking amount and instalments spread till possession.

25. What is my responsibility for disbursement of instalments through HFIs?

It is the purchaser's responsibility to ensure timely disbursement of instalments from HFIs and no demand will be made by us to the HFIs for the same. To facilitate smooth payments, customers are required to agree to a pre-determined payment schedule and issue a mandate to the HFI to disburse payments as per the schedule. This will be done via a 'Mandatory Disbursement Form' at the time of signing the Sale Agreement.

26. Who will take care of the maintenance of Prestige Clairemont?

The maintenance will be taken care of by Prestige Property Management & Services. You can rest assured that Prestige Clairemont will be cared for by professionals.

27. Am I permitted to shift my booking?

No, you are not permitted to shift your booking either to a different block or to a different project.

28. What is the scheme for maintenance?

The scheme for maintenance is as under:

- A sum of Rs. 48/- per sqft. will be charged as the advance maintenance fee for the first year and will be collected at the time of closing of your accounts. From the second year onwards, maintenance charges will levied on a quarterly basis payable in advance. All future payments are to be made favouring the property management company.
- An additional sum of Rs. 50/- per sqft. corresponding to the super built-up area will be collected as Sinking Fund. This amount will be deposited in an Escrow Account and the accruals will be used for major expenditure.

29. Will there be a validity to the price list?

The prices are subject to change from time to time, subject to the discretion of the Management.

30. What is the main source of water?

Water will be obtained through the available ground water and HMWSSB supply. Water Recycling Plants, Rainwater Harvesting and other methods for optimum use of water resources are planned.

31. What happens if I have any more questions/clarifications?

Please email us at: hyd@prestigeconstructions.com. OR Contact us on Toll Free: 1800-313-0080/ Corporate Office Land line: 040-23351440/41, 080-2559 1080. OR Meet us at: Prestige Estates Projects Ltd., Level 1, Merchant Towers, Road No: 4, Banjara Hills, Hyderabad - 500034 OR Prestige Estates Projects Ltd., 'The Falcon Towers' No 19, Brunton Road, Bengaluru - 560025.

NOTES

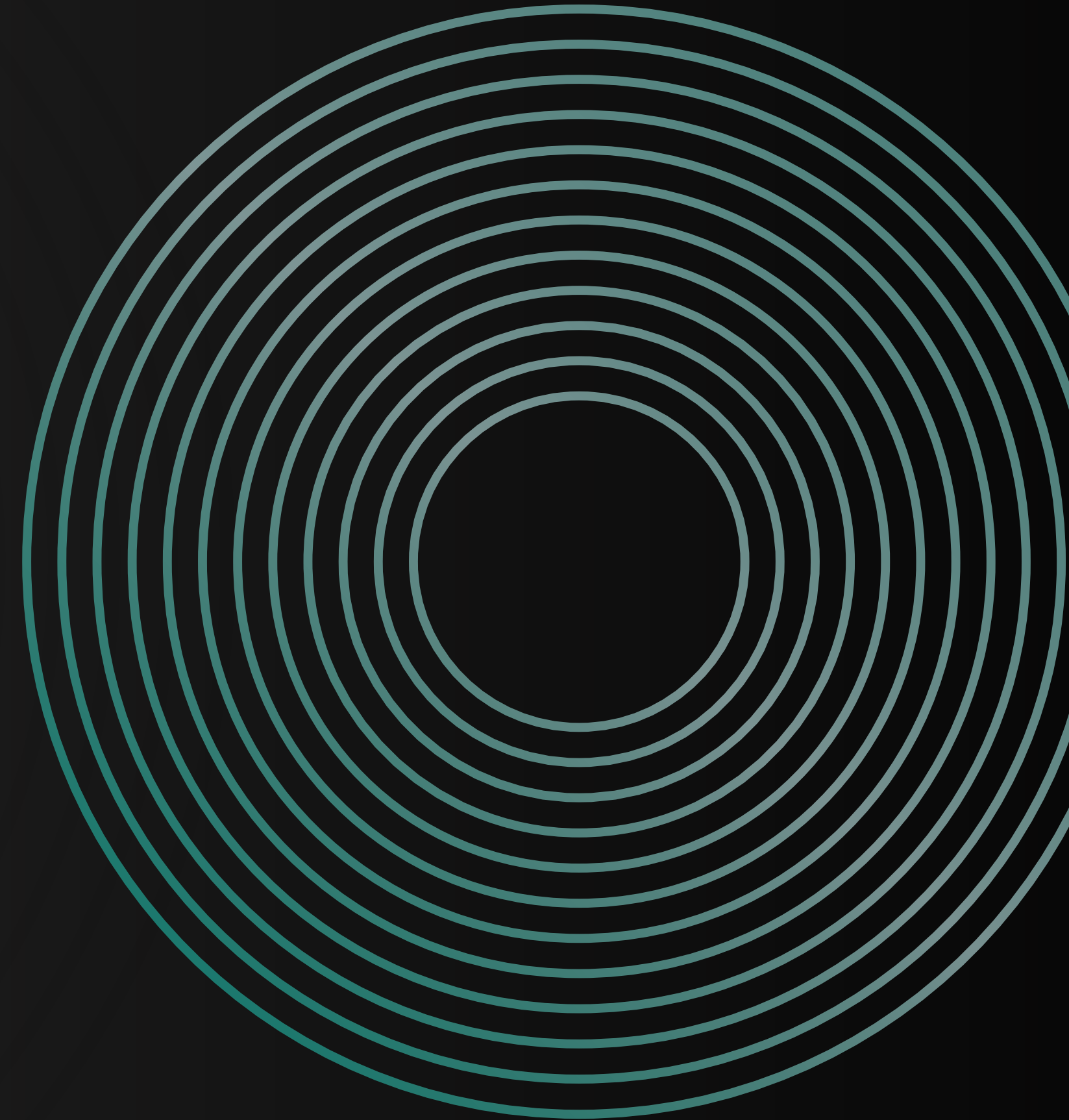



• HOMES • OFFICES • SHOPPING MALLS • HOTELS • INTERIORS •

Bengaluru | Chennai | Goa | Hyderabad | Kerala | Mangaluru | Delhi-NCR
Mumbai | Ahmedabad | Dubai Sales Office

Prestige Estates Projects Limited

Level 1, Merchant Towers, Road no: 4, Banjara Hills, Hyderabad – 500034 |

| E-mail: hyd@prestigeconstructions.com

Prestige Estates Projects Limited

Prestige Falcon Towers, No.19, Brunton Road, Bengaluru - 560025, Karnataka, INDIA.



This brochure is conceptual and has been prepared based on the inputs provided by the Project Architect. This may vary during execution. The Promoter reserves the right to change, alter, add or delete any of the specifications mentioned herein based on site conditions and construction exigencies without prior permission or notice. The external color schemes and detailing of landscape may vary as may be suggested by the Architect considering the site conditions.

The furniture shown in the plans is only for the purpose of illustrating a possible layout and does not form a part of the offering or specifications. All apartment interior views do not depict the standard wall, color and ceiling finishes and are not part of the offering.

Further, the dimensions mentioned do not consider the plastering thickness and there could be marginal variation in carpet areas.

