

# CLASSY MULTI-LEVEL CLUBHOUSE

## ALL TO YOURSELF

Nestled amongst the residential blocks in the heart of AR Homes Rise, a leafy path leads to the classy multi-level clubhouse. Set in an independent building of its own, it offers an uninterrupted access to resort style amenities. The ritzy retreat clearly means the residents never need to leave the security of the gated community, and yet everyone gets a chance to immerse in a recreational activity of their choice. So whenever you have leisure time at hand, simply step down from your home and enjoy!



FIND EASY ESCAPES AS AMAZING REJUVENATING AMENITIES AWAIT WITHIN. TAKE A DIP ANYTIME IN THE INFINITY SWIMMING POOL. LET ASANAS AND MEDITATION TRANSFORM YOU. FEAST YOUR EYES/JOG ON THE HEALTHY VISION OF ENDLESS GREEN. TRY AND BAG SOME WINS PLAYING GAMES. PARTY/CELEBRATE SPECIAL MOMENTS WITH FAMILY AND FRIENDS. OR INDULGE AS YOU LIKE, ALONE OR WITH SOMEONE.

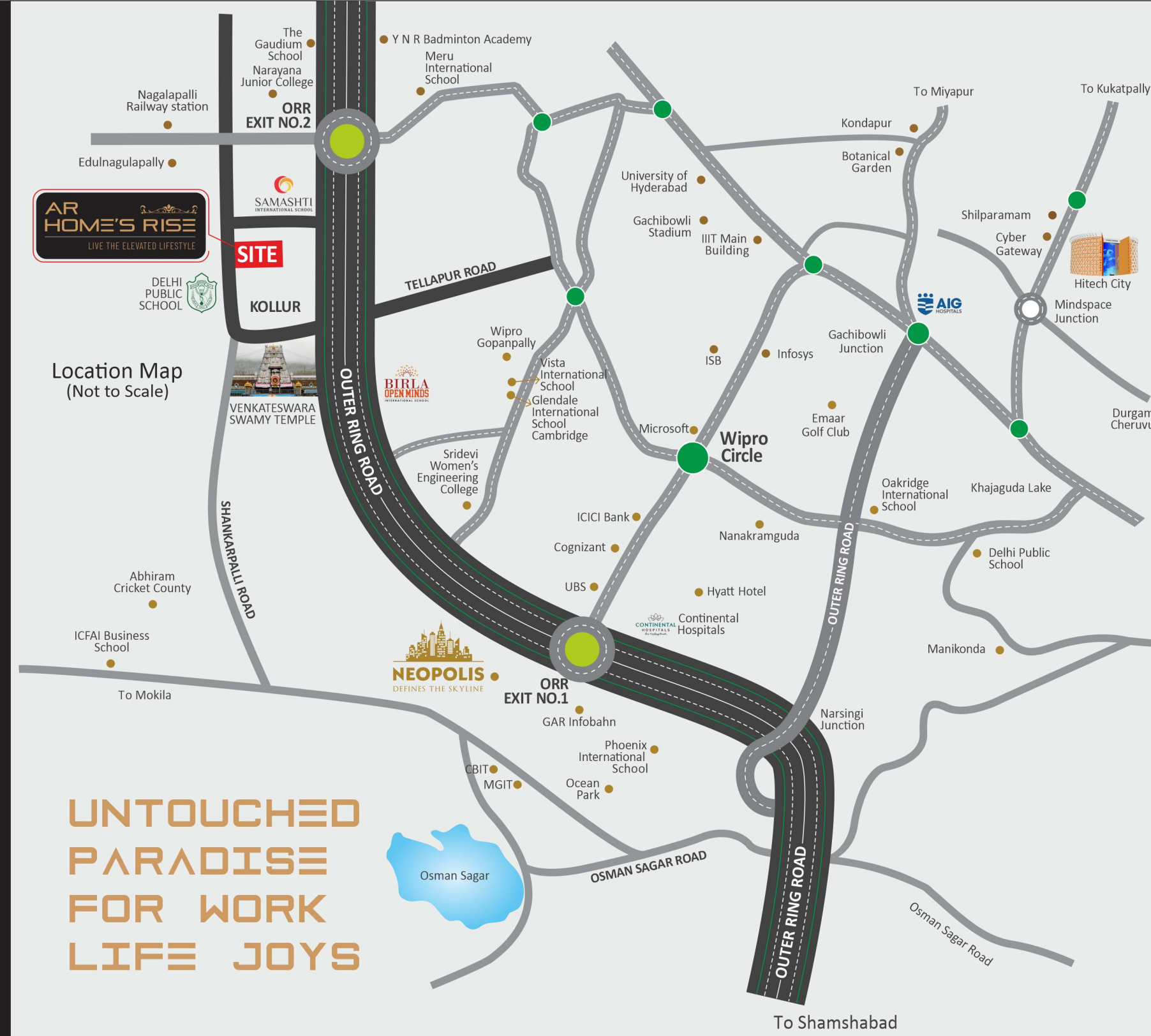

## UNTOUCHED PARADISE FOR WORK LIFE JOYS



To begin with, Kokapet, Financial District and Gachibowli as work hubs never disappoint. Even better, Kollur is a hidden gem - less crowded, no busy streets and nothing but greenery for miles around. So why not take advantage of it and bring some work-life balance in your life! And with reputed schools in the vicinity, healthcare services nearby and elegant eateries in the neighbourhood, the site is a delight for everyone. What's more, the ORR around makes connectivity a breeze!



Scan me for Location



Scan me for Website

Office Address:  
5th Floor, Sri Dheera's North East, Plot #101,  
Road No. 2, Kakatiya Hills, Madhapur, Hyderabad - 500 033.  
Site Address:  
AR Homes Rise, Survey No. 42 & 43, Kolluru Village,  
Ramchandrapuram (MD), Sangareddy Dist., Telangana - 502 300.

For more details contact  
**+91 7833 000 444 / 7833 000 666**  
sales@arhomes.in www.arhomes.in



Note: This brochure is only a conceptual presentation of the project and not a legal offering. The promoters reserve the right to alter and make changes in elevation, specifications and plans as deemed fit.



# AR HOME'S RISE

## LIVE THE ELEVATED LIFESTYLE

Ts RERA NO: P01100007000



# HARMONY

Embrace new age skyhomes with unhindered indoor and outdoor luxury living in one of Hyderabad's most picturesque and pristine suburbs. Soak up sunrises and sunsets, invite fresh air and natural light, enjoy commanding views of the city. Feel a vivacious vibe that can rival villa lifestyle. Get privileged access to world-class facilities and resort style recreation choices. Live minutes away from the ORR that breezily connects the city's urban centers. Look no further. Rise up to the richness of AR Homes Rise.

Total Land Area <b>Ac 6-27 Gts</b>	No of Units <b>750 Flats</b>	No of Floors <b>C+P1+P2+15</b>	Amenities with <b>65,000 SFT</b>
<b>2, 2.5, 3 &amp; 4 BHK</b> <small>Premium lifestyle apartments</small>	Variants of Flats <b>1300 sft to 3605 sft</b>	Approvals <b>RERA, HMDA</b>	Open Space <b>65%</b>

### PROJECT HIGHLIGHTS

- + GRAND ARRIVAL & SECURITY COMPLEX
- + NO COMMON WALLS
- + VASTU COMPLIANT
- + HIGH-END DESIGN ARCHITECTURE
- + SUPERIOR QUALITY CONSTRUCTION
- + EXCLUSIVE CLUBHOUSE
- + SPACIOUS FLOOR PLANS
- + FUTURISTIC LOCATION
- + QUALITY FIXTURES & FITTINGS
- + ADVANCED SEWAGE TREATMENT PLANT
- + CLEAN & POLLUTION FREE NEIGHBOURHOOD
- + LAVISH DESIGNER LANDSCAPING
- + 24 HRS TREATED WATER SUPPLY
- + 100% GREENERY VIEW EACH FLAT
- + WALKING AND JOGGING TRACKS
- + RAINWATER HARVESTING
- + LARGE SPACIOUS BALCONIES
- + 3 LEVEL PARKING
- + EV CHARGING STATION
- + MAXIMUM LIVING SPACE WITH MINIMAL WASTAGE
- + FIRE FIGHTING SYSTEM
- + 100% DG BACKUP
- + 24 HRS PROFESSIONAL SECURITY WITH CC CAMERAS

GATED COMMUNITY APARTMENT @ KOLLUR, HYDERABAD  
[www.arhomes.in](http://www.arhomes.in)

CREATIVE ETHICS.COM  
+91 9 0129 32553

### CLUB HOUSE AMENITIES

- DOUBLE HEIGHT LOBBY AND RECEPTION
- DEPARTMENTAL STORE
- FACILITY STAFF ROOM
- PHARMACY
- CAFÉ
- BANQUET HALL WITH KITCHEN AND DINING
- INDOOR PLAY AREA AND SEATING AREA
- MODERN GYM
- MINITHEATER ROOM
- DAY CRECHE
- CO-WORKING SPACE
- AEROBICS/MEDITATION/ YOGA HALL
- TWO NOS DOUBLE HEIGHT BADMINTON COURTS
- LIBRARY
- CLINIC
- ASSOCIATION OFFICE
- MAINTENANCE OFFICE
- CONFERENCE HALL
- INFINITY POOL FOR ADULTS AND KIDS
- CHANGING ROOMS, REFRESHMENT AREA
- LADIES AND GENTS SALOON
- 4 GUEST BEDROOMS

### LIFESTYLE AMENITIES

- GRAND ARRIVAL & SECURITY COMPLEX
- BUS BAY & PICK UP ZONE
- ARRIVAL WATER BODY
- KIDS PLAY AREA
- PERGOLAS WITH CREEPERS
- ELDERLY SEATING AREA
- SURPRISE GARDEN & YOGA DECK
- JOGGING TRACK
- AMPHITHEATER
- AROMA GARDEN
- HALF BASKETBALL COURT
- CRICKET NET
- INFORMAL SEATING ALCOVES
- OUTDOOR CHESS COURT
- OUTDOOR FITNESS STADIUM
- TODDLER PLAY AREA
- SKATING RINK
- SCULPTURE COURT
- OUTDOOR CO-WORKING SPACE
- TREE COURT
- BADMINTON COURT
- MULTI PURPOSE LAWN
- CONNECTING TRELLIS
- CHIT CHAT GARDEN

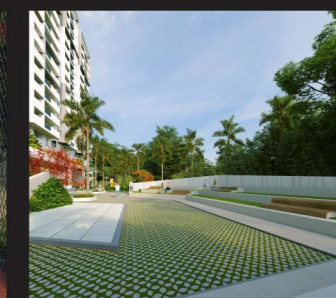

RELAX AND RELISH ANY TIME

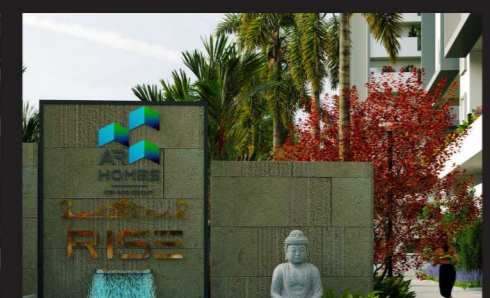

BASK IN LUXURY AND ADD A TOUCH OF INDULGENT STYLE TO YOUR MUNDANE URBAN LIFESTYLE AT AR HOMES RISE.

BIG APARTMENTS WITH

# 180-DEGREE

CITY VISTAS FOR LUXE LIFESTYLE OF THE HIGHEST LEVEL



WITH SWEEPING 180-DEGREE CITY VISTAS FROM BREATHTAKINGLY BIG BALCONIES, COME HOME TO LIGHT-FILLED, LARGE HEARTED BUNGALOW-LIKE SPACIOUS APARTMENTS WITH FLOWING LAYOUT, SPECTACULAR VIEWS, AND RESORT-LIKE AMENITIES.

WELCOME TO AR HOMES RISE, WHERE YOU CAN TRULY RISE ABOVE COMPACT LIVING WHILE RAISING YOUR STANDARD OF LIFESTYLE.

REVEL IN THE GAME OF

# LEISURE

with a quality that has no equal and a finish that will connote elegance, come make AR Homes Rise yours.



### STRUCTURE & SUPERSTRUCTURE

RCC framed structure with CC blocks outer walls 9" thick and internal walls 4.5" thick.

PLASTERING: External single coat cement plaster and internal double coat cement plaster.

### DOORS & WINDOWS

Main Door: Seasoned hardwood frame with designer veneer laminated door with melamine polish fitted with reputed make hardware (Dorset/equivalent).

Internal doors: Seasoned hardwood frame with flush doors with designer laminated door with reputed make hardware (Dorset/equivalent).

Toilet & Utility: WPC doors with reputed make hardware /as specified in internal doors.

### FLOORING

800X800 mm / 600X1200 mm Double charged vitrified tiles / GVT for all Bedrooms, Kitchen, Living, Dining, Drawing rooms.

Toilet: Acid resistance anti skid ceramic tiles of reputed make and dado up to door height.

Utility & Balcony: Acid resistance anti skid ceramic tiles of reputed make. Dado upto 4' height in Utility.

Staircase: Natural stone flooring with edge chamfering / polish.

Corridor: Double charged vitrified tiles/GVT.

Parking: VDF with groove making.

### PAINTING

External: Textured smooth finish + 1 coat oil based primer + two coats of external emulsion paint of reputed make.

Internal: Smooth Putty finish + 1 coat primer + 2coats of premium emulsion paint of reputed make.

### ELECTRICAL AND COMMUNICATION

Cables: FRLS Concealed copper wiring of FINOLEX / FINECAB / GOLDMEDAL / equivalent make.

Switches: Modular switches in all rooms of LEGRAND / ANCHOR / ORIENT / equivalent make.

AC: Power outlet provision in all Bedrooms, Living, Dining, Drawing rooms.

Power outlet provision for Geyser, Exhaust Fan in all Toilets.

Kitchen: Power plug for Cooking Range, Chimney, Refrigerator, Microwave Oven, Mixer / Grinder. Plug point for Refrigerator.

EV Charging Station, CC Cameras, Solar Fencing.

### PLUMBING AND SANITARY

EWC with flush tank/Flush valve of Hind ware/QUEO/ KOHLER or equivalent make.

Wash basin in all Toilets and provision for Dining area.

All water lines are CPVC and drainage lines are PVC of ASHIRVAD / ASTROL / equivalent make

Hot and cold water wall Diverter with shower.

Provision for geyser in all Toilets.

### KITCHEN

Provision for designer Modular Kitchen. Electrical points to suit the electrical appliances needed in the Kitchen.

Provision for Water Purifier, Exhaust Fan / Chimney.

Provision for Washing Machine in the Utility area.

### ELEVATORS/LIFTS

Automatic passenger, Service lifts of KONE / SCHINDLER / Equivalent brand with front tiles cladding.

### GENERATOR

100% DG BACK UP